

www.teknikoffice.co.uk

Teknik

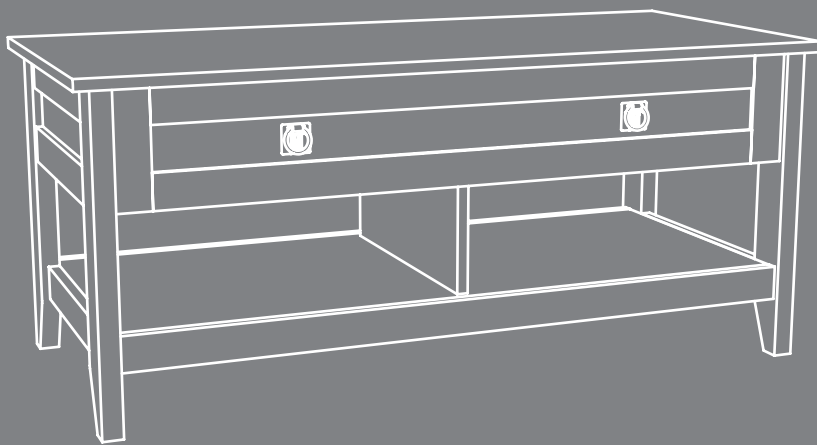

It's addictive.

Home Study Lift Up Coffee/Work Table

Model 5426055

Table of Contents

Assembly Tools Required

Part Identification	3
Hardware Identification	4
Assembly Steps	5-29
Français	30-33
Español	34-37
Safety	38
Warranty	39

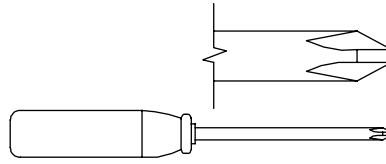

No. 2 Phillips Screwdriver
Tip Shown Actual Size

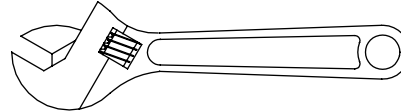

Adjustable Wrench

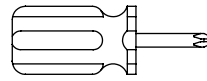

Short Screwdriver

Part Identification

Now you know
our ABCs.

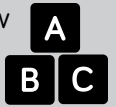

⚠ While not all parts are labeled, some of the parts will have a label or an inked letter on the edge to help distinguish similar parts from each other. Use this part identification to help identify similar parts.

A	RIGHT END (1)	F	STRETCHER (1)	N	END MOLDING (4)
B	LEFT END (1)	G	RIGHT FRONT/LEFT REAR LEG (2)	O	UPRIGHT (1)
C	TOP (1)	J	LEFT FRONT/RIGHT REAR LEG (2)	P	BRACE (1)
D	SHELF (1)	L	SHORT SKIRT (2)	Q	FRONT PANEL (1)
E	BOTTOM (1)	M	LONG SKIRT (2)	R	BACK PANEL (1)

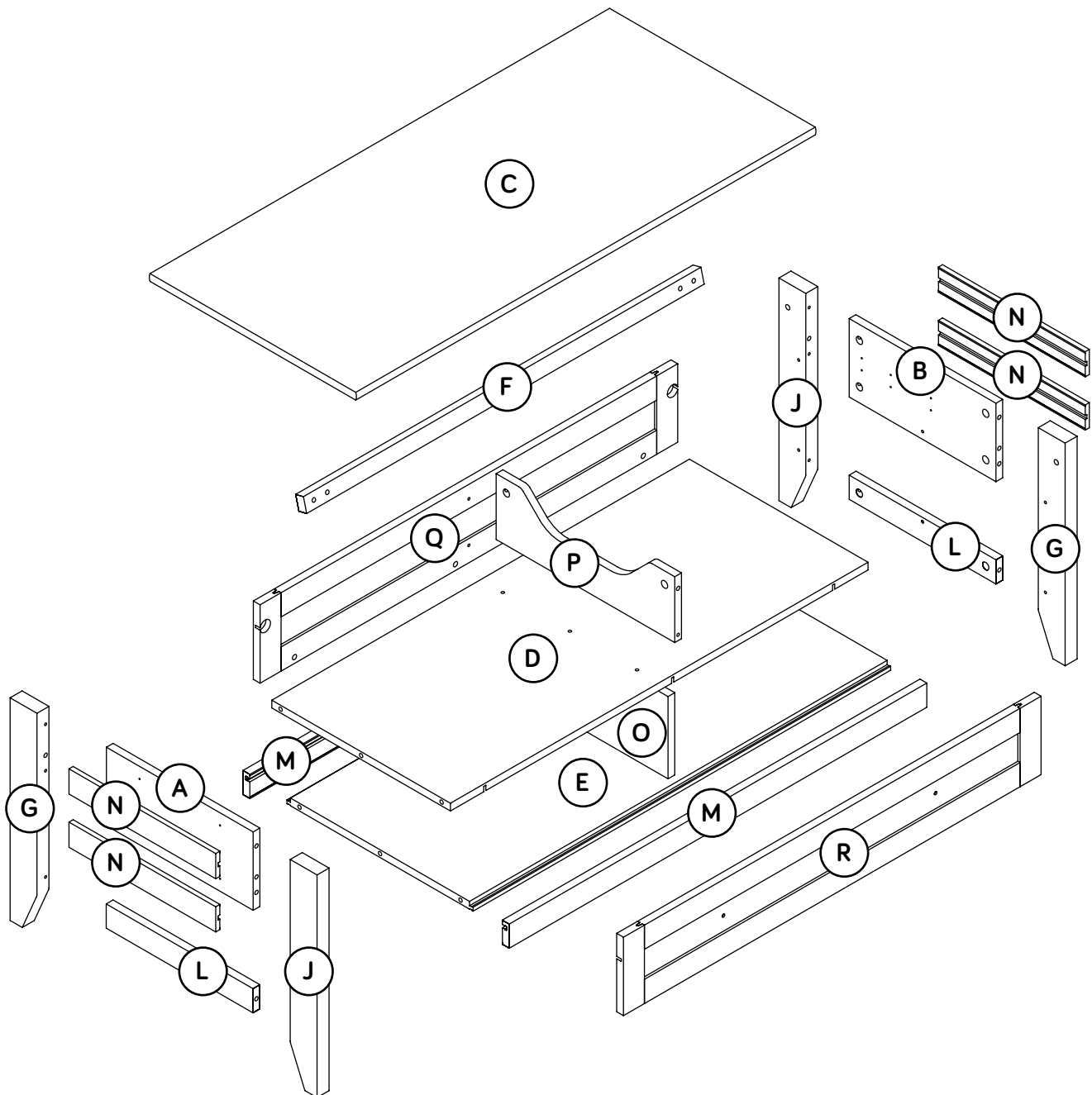

Hardware Identification

↑ Screws are shown actual size. You may receive extra hardware with your unit.

1F HIDDEN CAM - 26

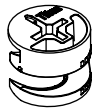

8F CAM SCREW - 26

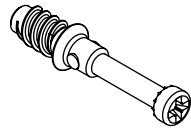

11F TWIST-LOCK® FASTENER - 10

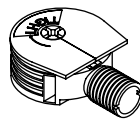

15F WOOD DOWEL - 4

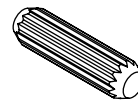

37G SUPPORT BRACKET - 2

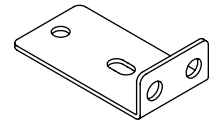

10I PLASTIC WASHER - 2



22K PULL - 2

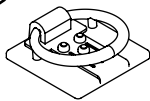

2M BUMPER - 6

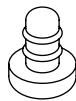

13M SMALL METAL WASHER - 8

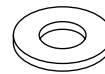

24M NUT - 8



23M LIFT TABLE MECHANISM SET - 1

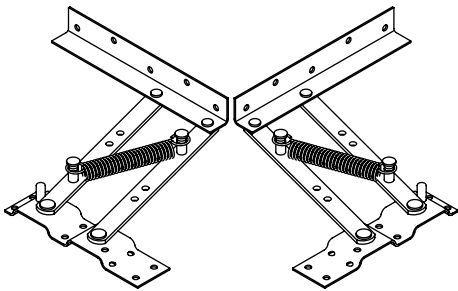

80M LARGE METAL WASHER - 2

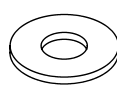

91M BUSHING - 2



100P APPLIQUE CARD - 5

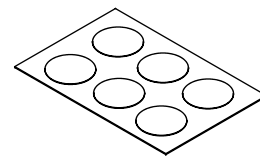

1R METAL PIN - 2

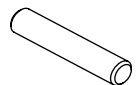

1S BLACK 9/16" LARGE HEAD SCREW - 16

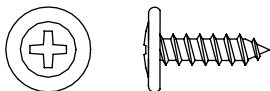

32S BLACK 9/16" FLAT HEAD SCREW - 8

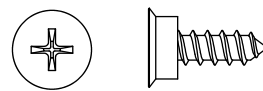

61S SILVER 1/4" MACHINE SCREW - 2

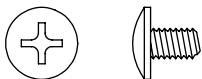

85S BLACK 3/4" PAN HEAD SCREW - 2



92S BLACK 3/4" MACHINE SCREW - 4

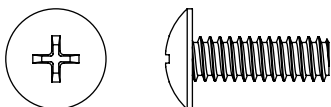

93S BLACK 1-1/4" MACHINE SCREW - 4

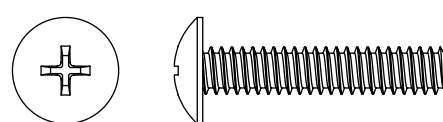

113S BLACK 1-15/16" FLAT HEAD SCREW - 6

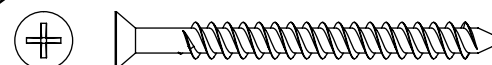

Hardware Usage Guide

HOW TO USE A TWIST-LOCK® FASTENER

1. Push a TWIST-LOCK® FASTENER into the large hole in the part.

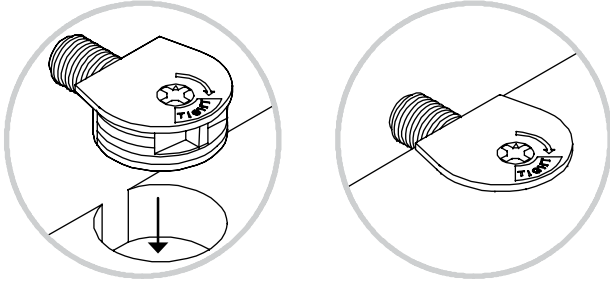

2. 1. Insert the dowel end of the FASTENER into the hole of the adjoining part.

NOTE: The dowel end of the FASTENER must remain fully inserted in the hole of the adjoining part while locking the FASTENER.

2. Tighten the FASTENER with a Phillips screwdriver as tight as possible.

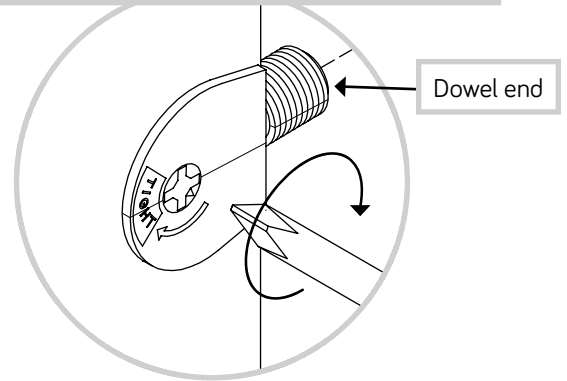

HOW TO USE A HIDDEN CAM & CAM SCREW

Cam Screw

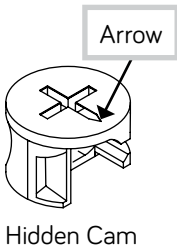
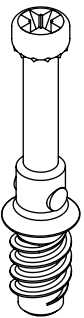

Hidden Cam

1. Turn the CAM SCREW until the shoulder is against the surface of the part.

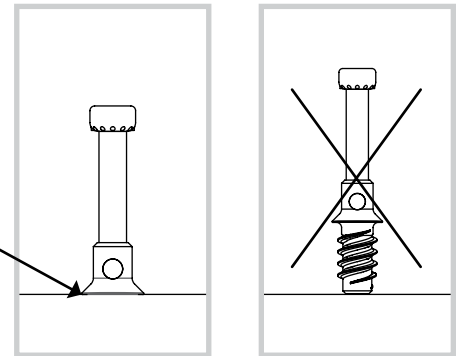

2. Push a HIDDEN CAM into the part. The arrow in the HIDDEN CAM must point toward the hole in the edge of the board.

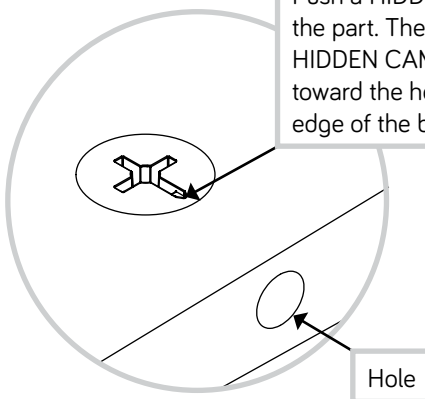

3. Insert the CAM SCREW into the HIDDEN CAM. Tighten the HIDDEN CAM.

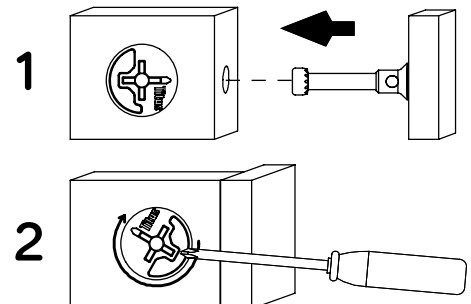

Step 1

- ✦ Assemble your unit on a carpeted floor or on the empty carton to avoid scratching your unit or the floor.
- ✦ To begin assembly, push eight SAUDER TWIST-LOCK® FASTENERS (11F) into the large holes in the SHELF (D) and FRONT PANEL (Q).

Do not tighten the TWIST-LOCK® FASTENERS in this step.

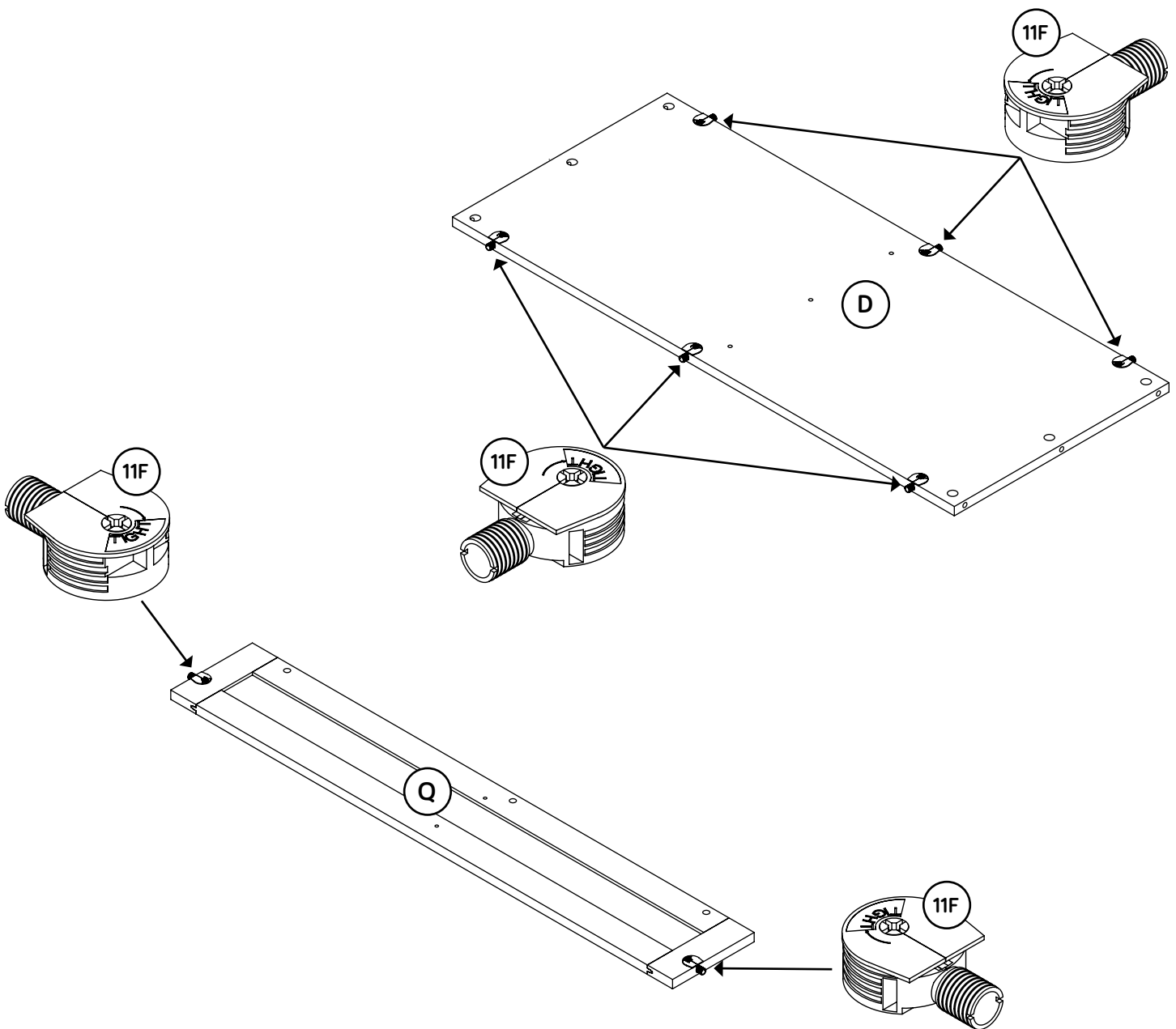

Step 2

- Fasten the SHELF (D) to the FRONT PANEL (Q). Tighten three TWIST-LOCK® FASTENERS.

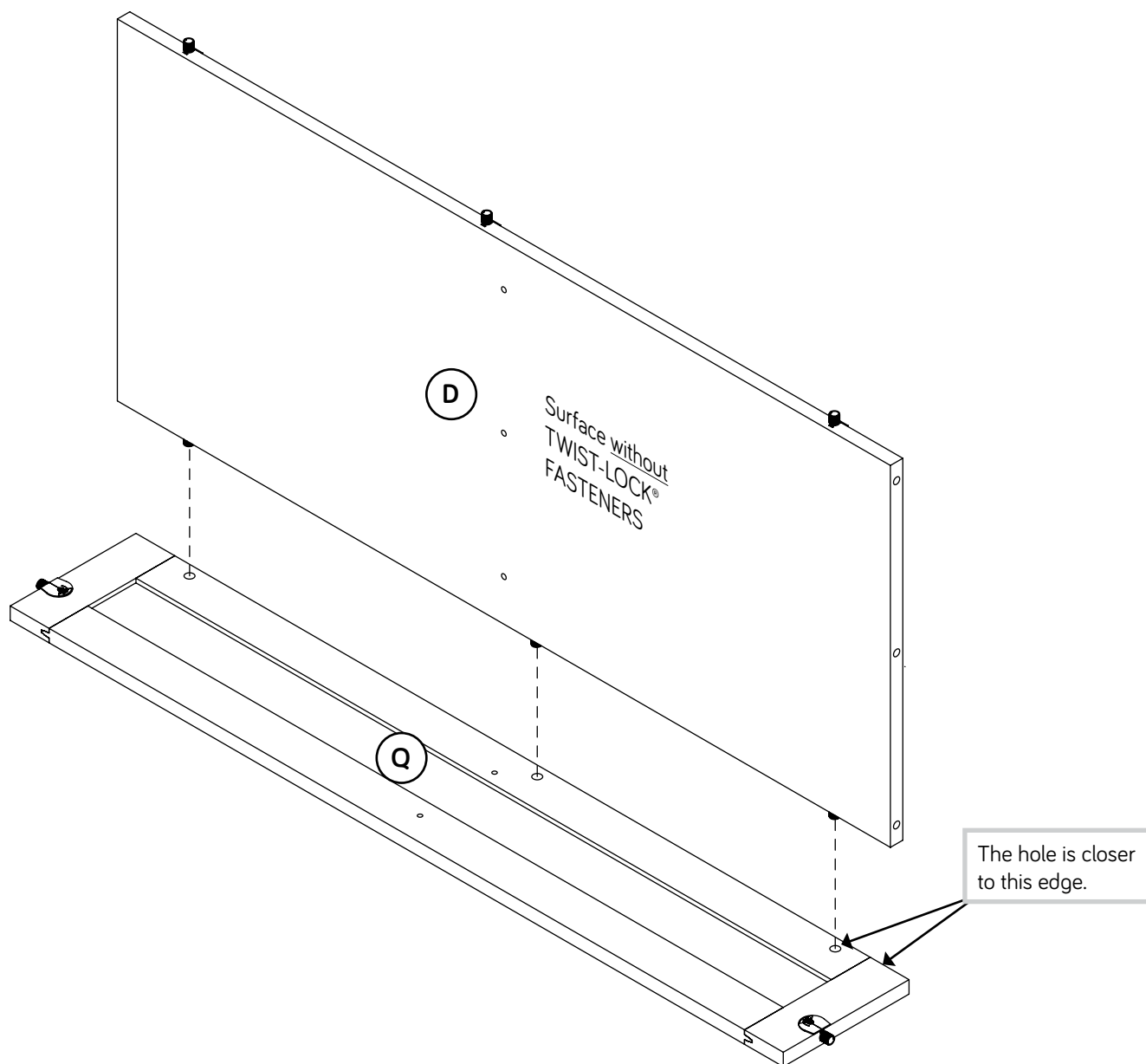

Step 3

- ✚ Fasten the UPRIGHT (O) to the SHELF (D). Use three BLACK 1-15/16" FLAT HEAD SCREWS (113S).
- ✚ NOTE: You should start each SCREW a few turns before completely tightening any of them.
- ✚ Turn one CAM SCREW (8F) into the FRONT PANEL (Q).
- ✚ Insert one METAL PIN (1R) into the FRONT PANEL (Q).

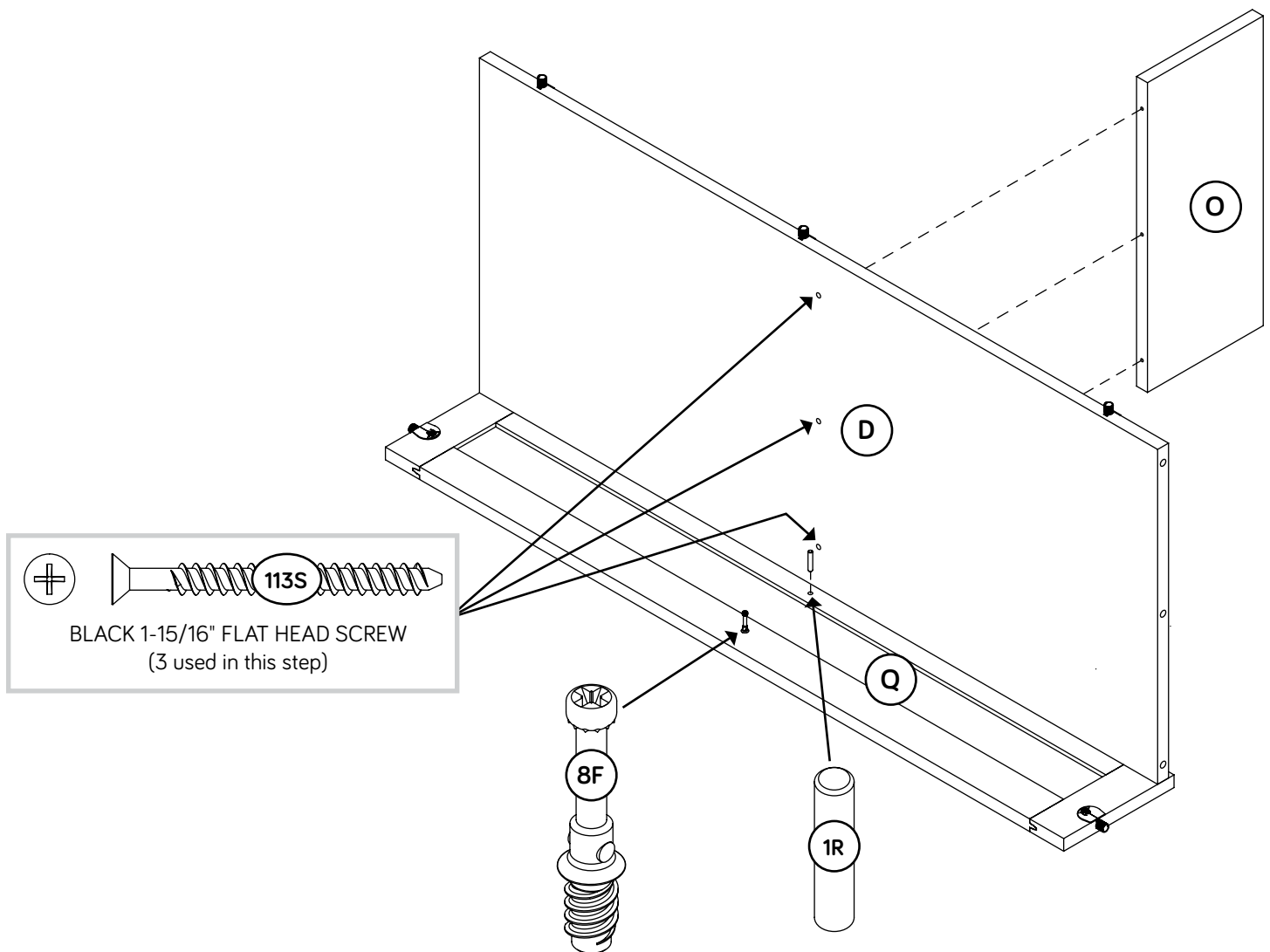

Step 4

- ✚ Push two HIDDEN CAMS (1F) into the BRACE (P).
- ✚ Fasten the BRACE (P) to the FRONT PANEL (Q). Tighten one HIDDEN CAM.
- ✚ NOTE: Be sure the METAL PIN in the FRONT PANEL inserts into the BRACE.

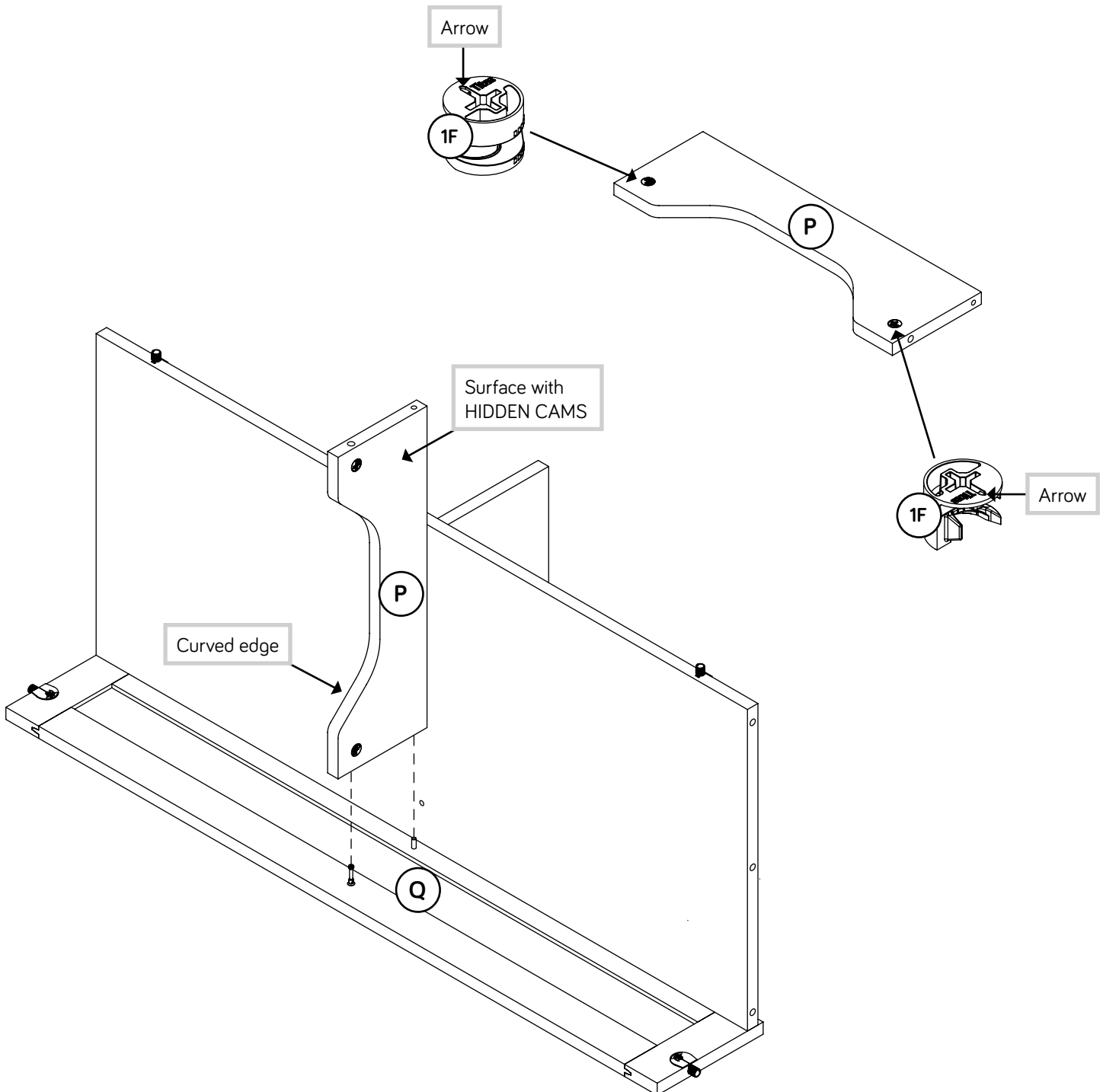

Step 5

- ✦ Push two SAUDER TWIST-LOCK® FASTENERS (11F) into the large holes in the BACK PANEL (R).
- ✦ Turn one CAM SCREW (8F) into the BACK PANEL (R).
- ✦ Insert one METAL PIN (1R) into the BRACE (P).
- ✦ Fasten the BACK PANEL (R) to the SHELF (D). Tighten three TWIST-LOCK® FASTENERS.
- ✦ Fasten the BACK PANEL (R) to the BRACE (P). Tighten one HIDDEN CAM.
- ✦ **NOTE:** Be sure the METAL PIN in the BRACE inserts into the BACK PANEL.

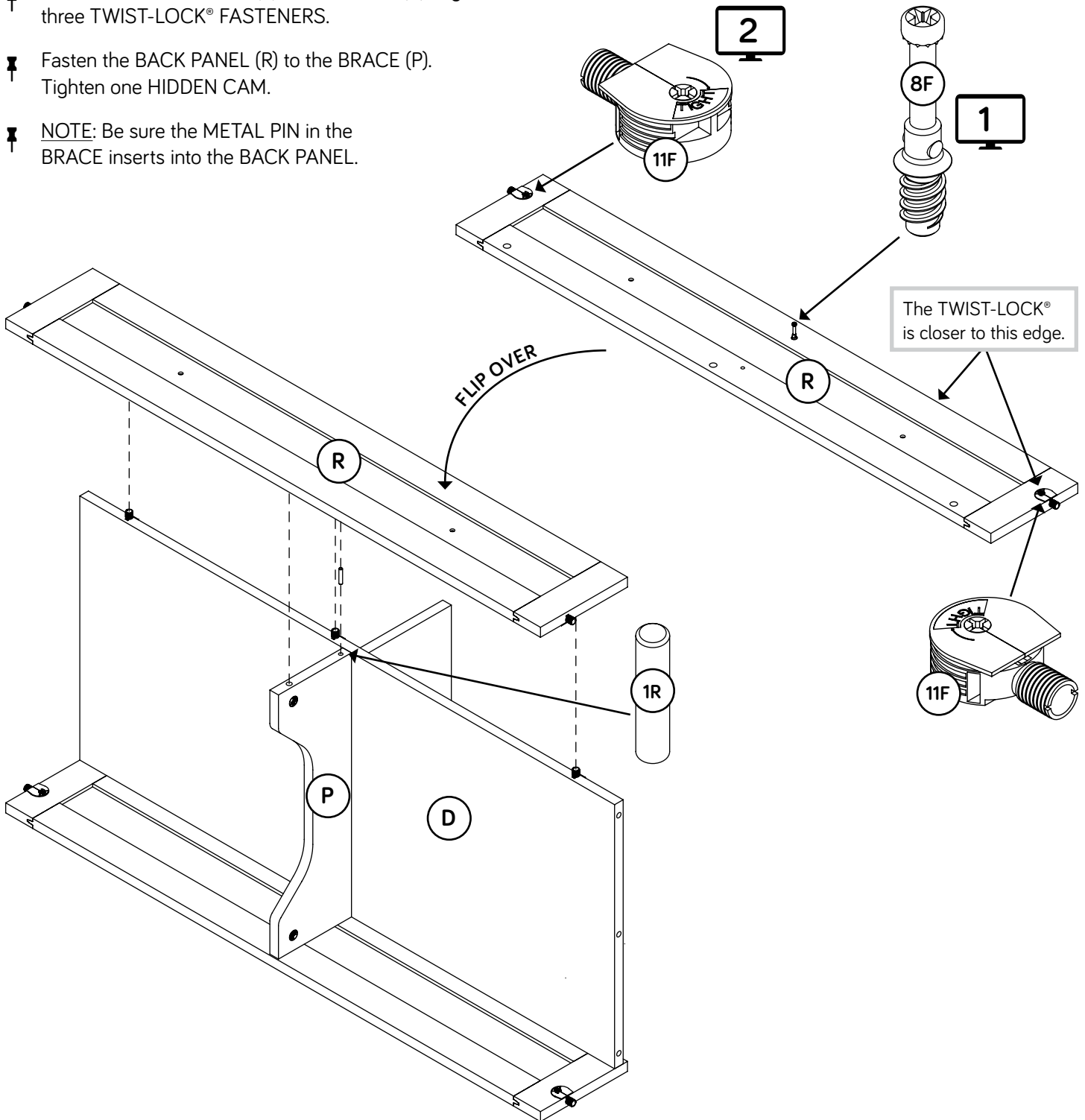

Step 6

- Fasten two PULLS (22K) to the BACK PANEL (R). Use two PLASTIC WASHERS (10I) and two SILVER 1/4" MACHINE SCREWS (61S).

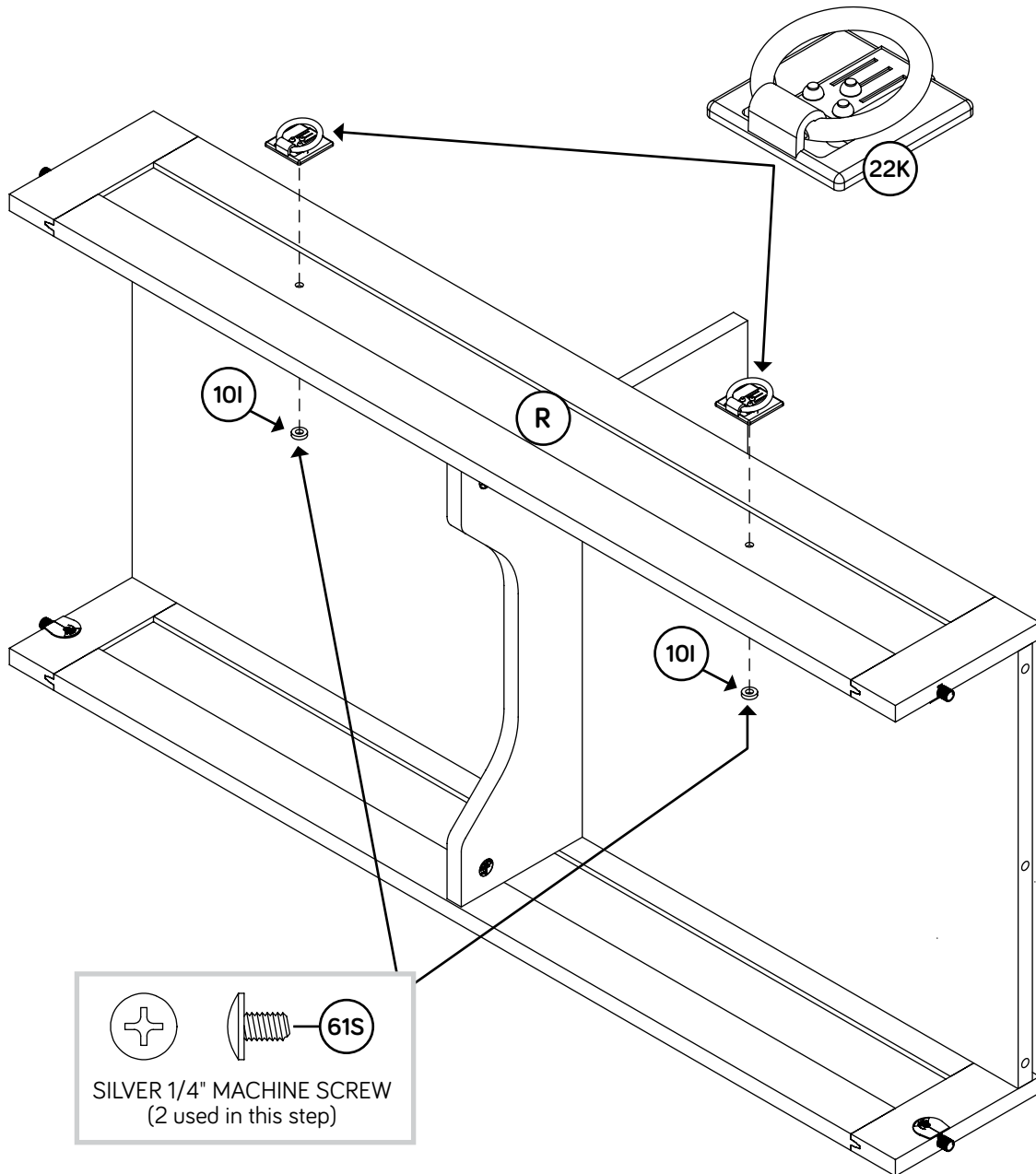

Step 7

✚ Turn four BLACK 9/16" FLAT HEAD SCREWS (32S) into the RIGHT END (A) until the shoulders of the SCREWS rest on the surfaces of the END.

✚ NOTE: Do not overtighten the SCREWS.

✚ Slide two END MOLDINGS (N) onto the RIGHT END (A). Line up the grooves in the MOLDINGS over the heads of the SCREWS in the END.

✚ NOTE: The MOLDINGS should be centered on the END.

✚ NOTE: If the MOLDING comes up off of the SCREWS, remove it and slide it on again.

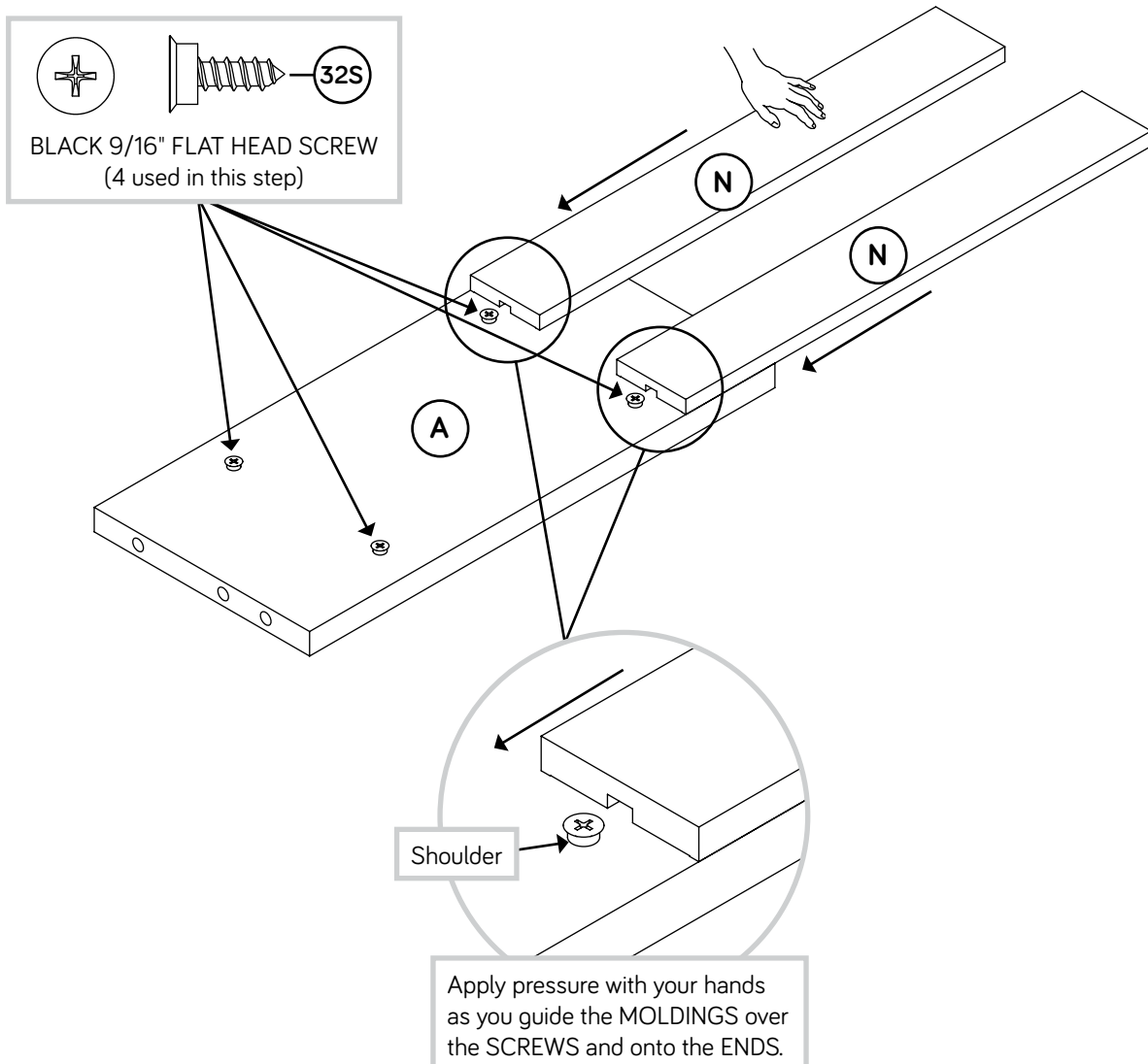

Step 8

- ✚ Carefully turn the RIGHT END (A) over.
- ✚ Push six HIDDEN CAMS (1F) into the RIGHT END (A) and one of the SHORT SKIRTS (L).
- ✚ Turn twelve CAM SCREWS (8F) into the RIGHT END (A), SHORT SKIRT (L), and two of the LEGS (G and J).
- ✚ Insert two WOOD DOWELS (15F) into the LEGS (G and J).

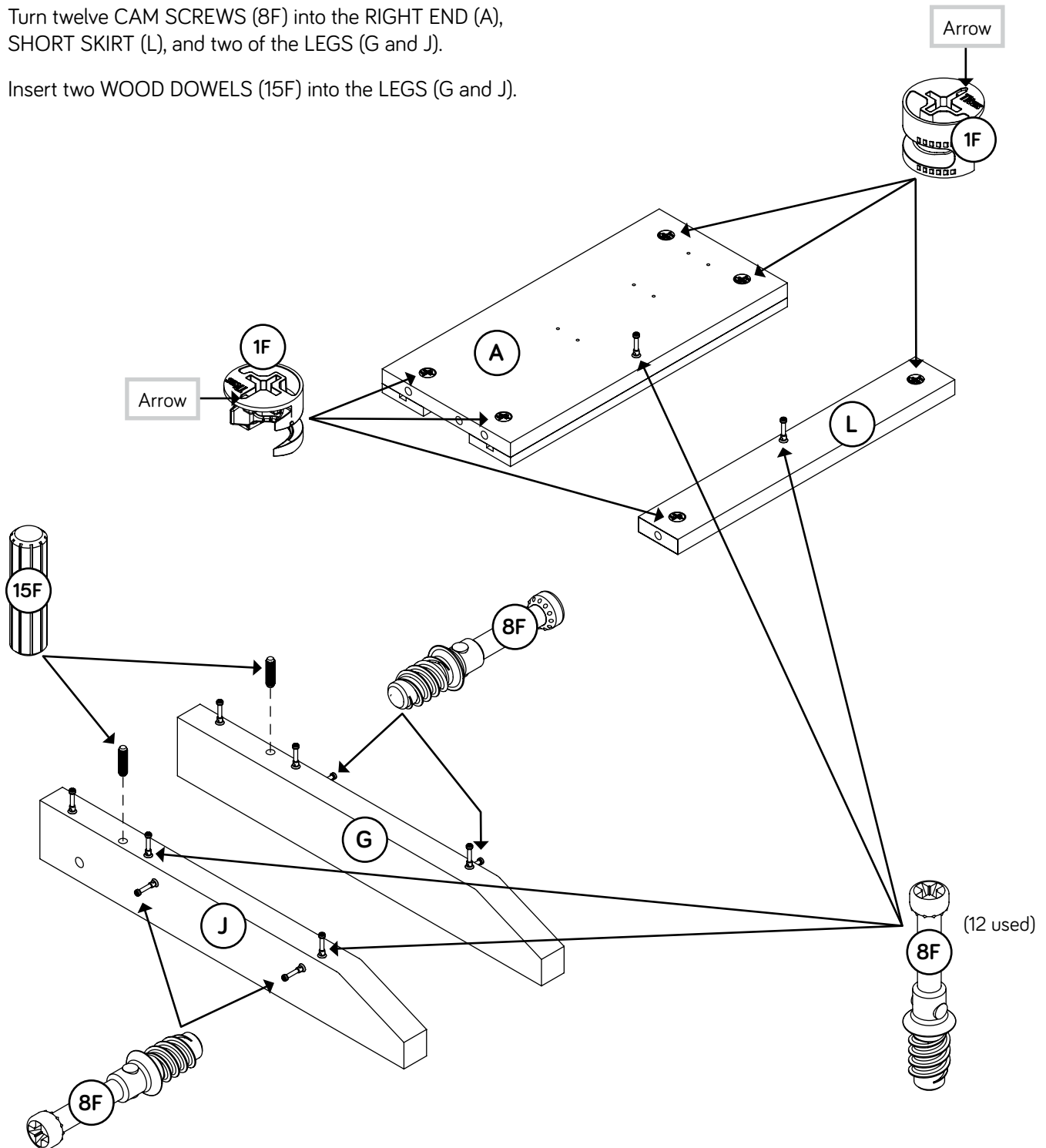

Step 9

- ✚ Fasten the LEGS (G and J) to the RIGHT END (A) and SHORT SKIRT (L). Tighten six HIDDEN CAMS.
- ✚ NOTE: Be sure the WOOD DOWELS in the LEGS insert into the RIGHT END.

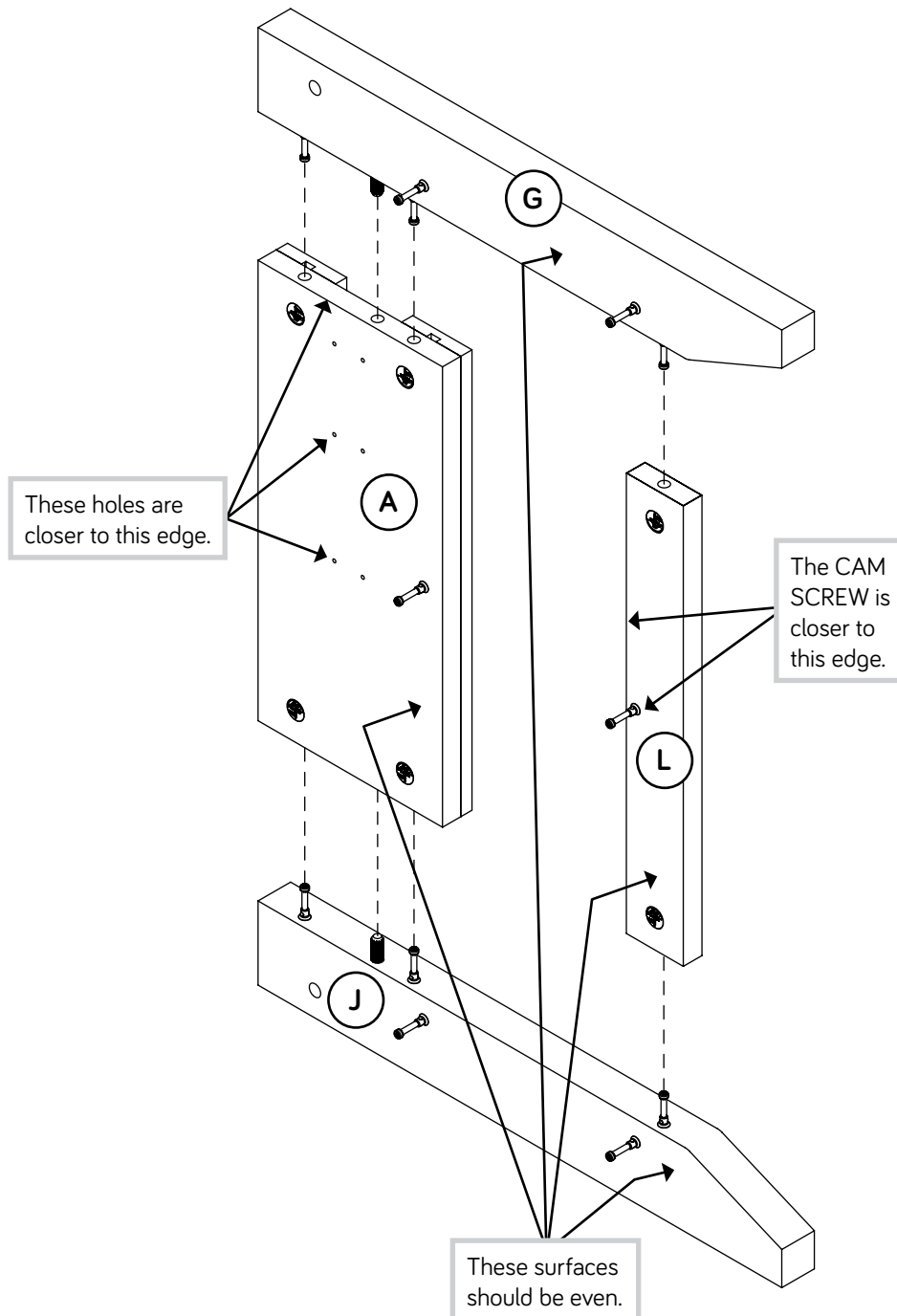

Step 10

- 🔩 **NOTE:** This step shows a different view of the assembled parts.
- 🔩 Push six HIDDEN CAMS (1F) into the SHELF (D).
- 🔩 Fasten the LEGS (G and J) to the PANELS (Q and R). Tighten two TWIST-LOCK® FASTENERS.
- 🔩 Fasten the RIGHT END (A) and LEGS (G and J) to the SHELF (D). Tighten three HIDDEN CAMS.

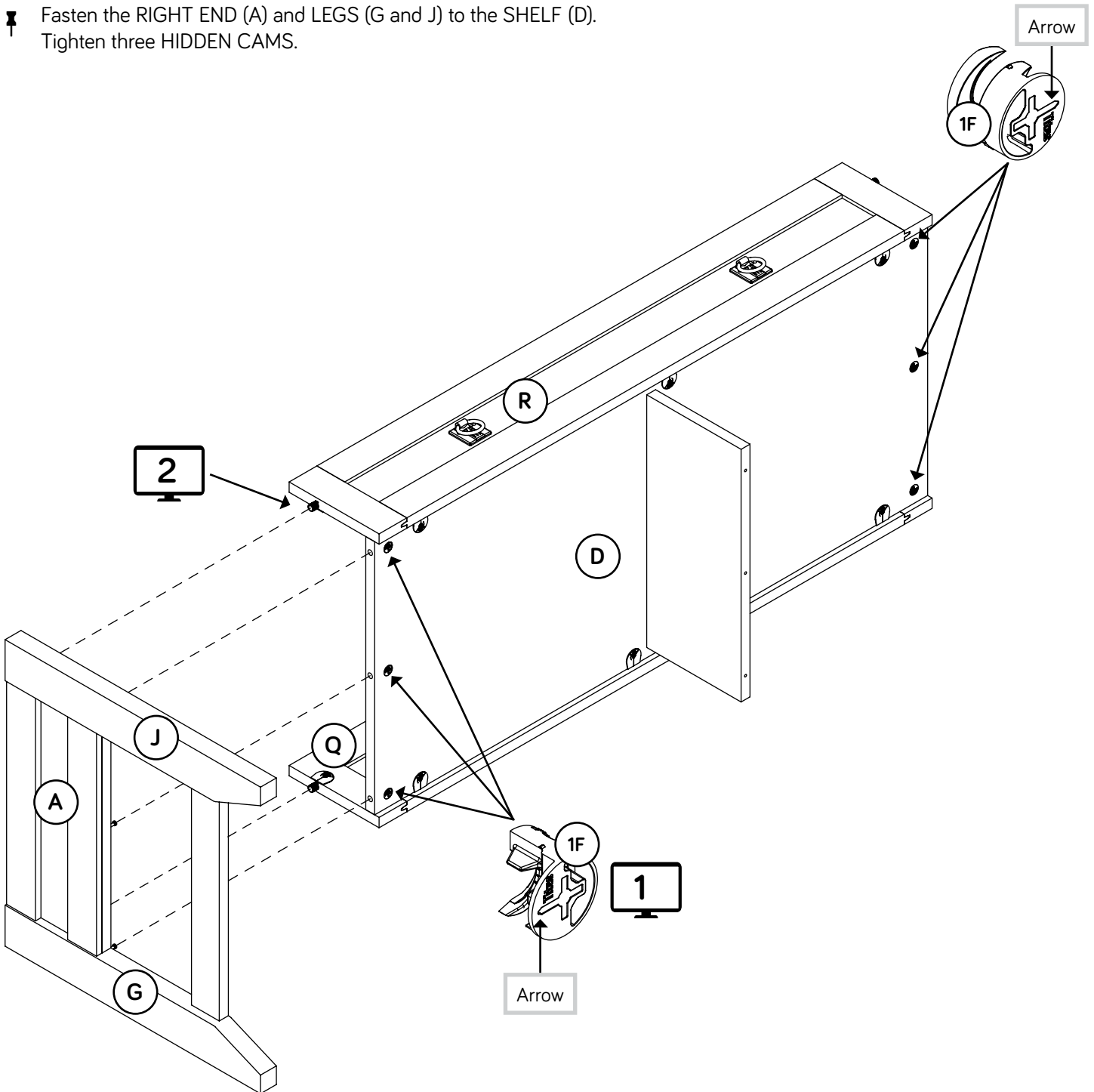

Step 11

- ✚ Push six HIDDEN CAMS (1F) into the BOTTOM (E).
- ✚ Slide the LONG SKIRTS* (M) onto the notched edges of the BOTTOM (E).
- ✚ *U.S. Patent No. 5,499,886

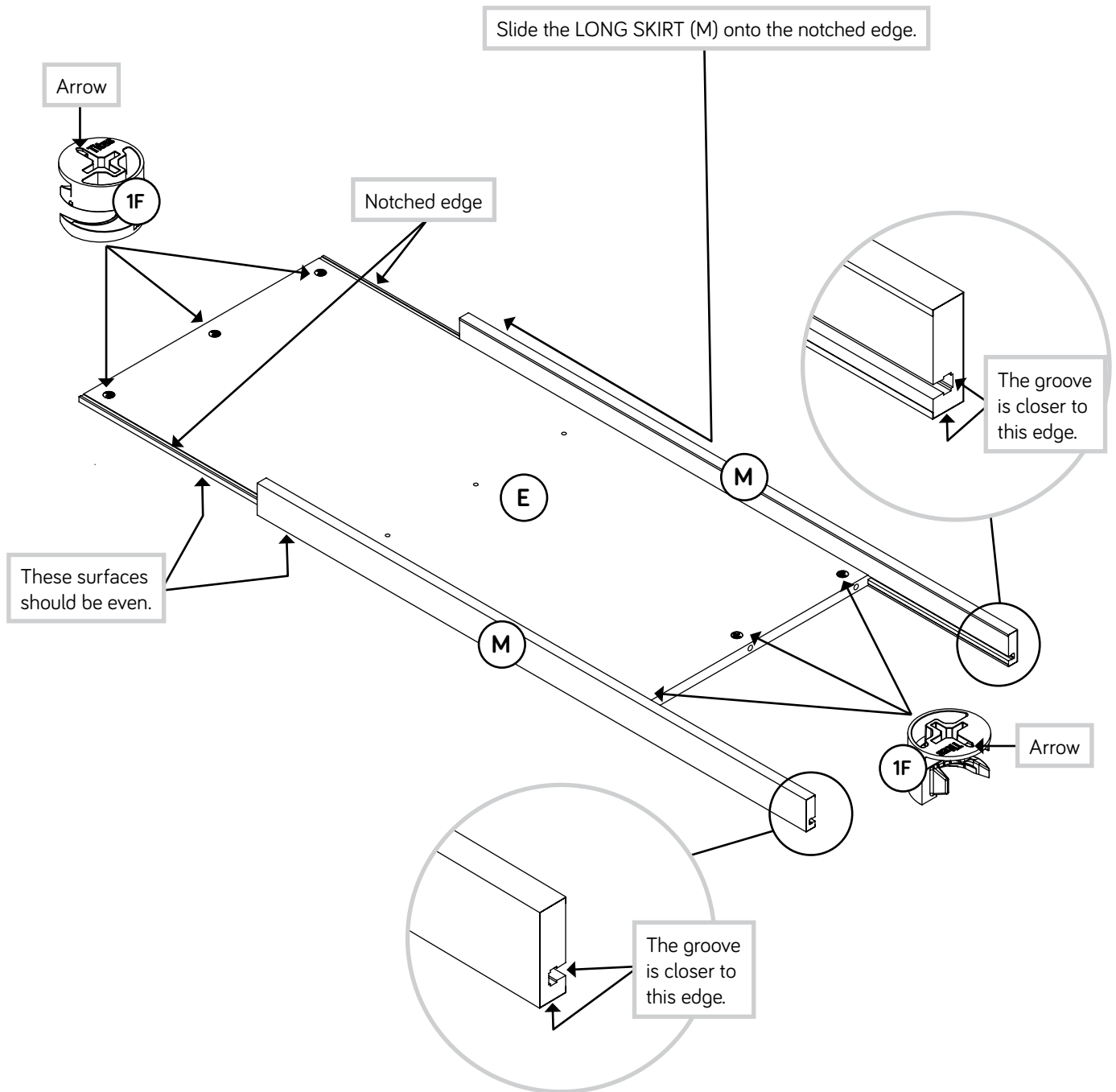

Step 12

- ✚ Fasten the BOTTOM (E) to the LEGS (G and J) and SHORT SKIRT (L). Tighten three HIDDEN CAMS.
- ✚ Fasten the BOTTOM (E) to the UPRIGHT (O). Use three BLACK 1-15/16" FLAT HEAD SCREWS (113S).
- ✚ NOTE: You should start each SCREW a few turns before completely tightening any of them.

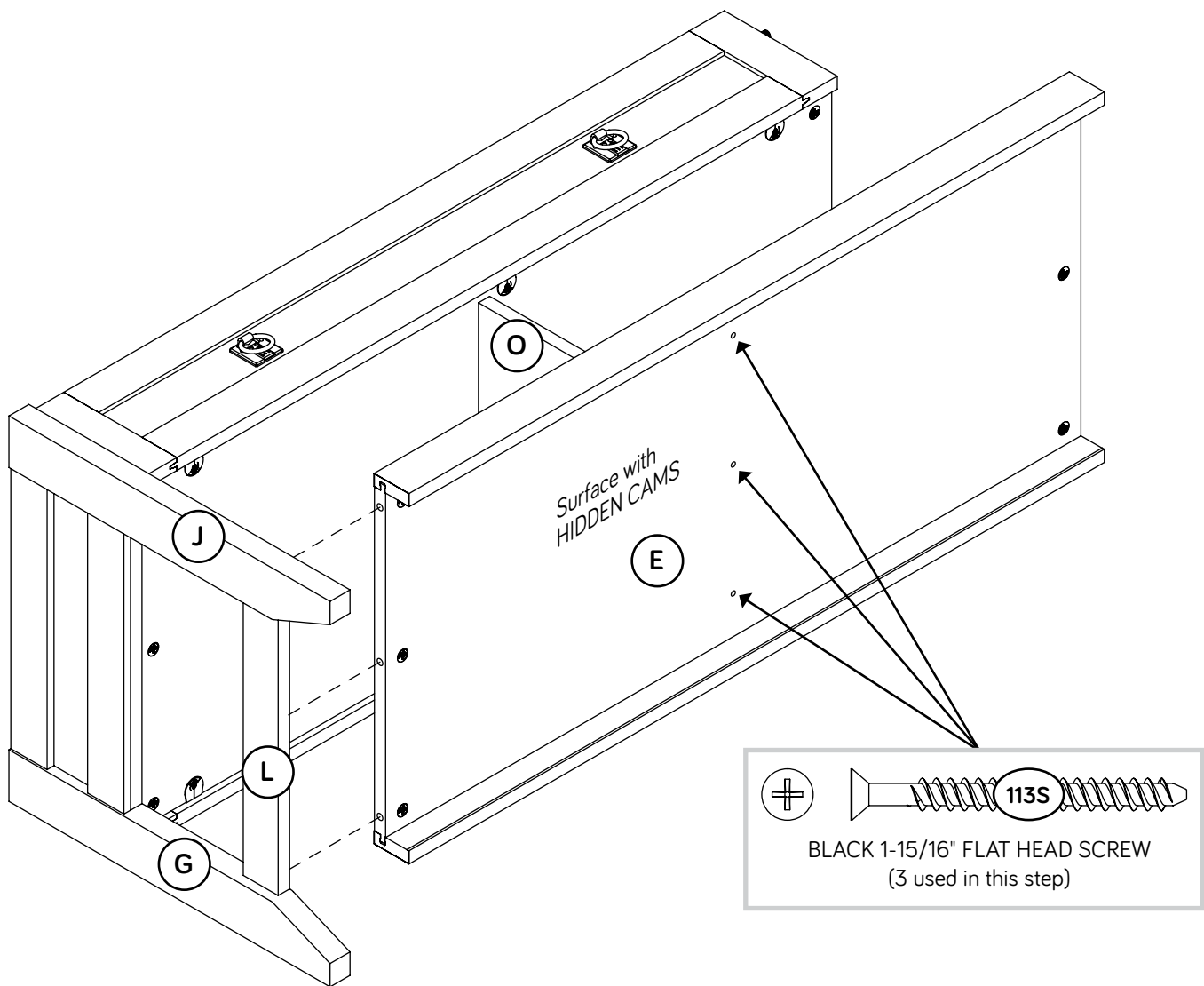

Step 13

✚ Turn four BLACK 9/16" FLAT HEAD SCREWS (32S) into the LEFT END (B) until the shoulders of the SCREWS rest on the surfaces of the END.

✚ NOTE: Do not overtighten the SCREWS.

✚ Slide two END MOLDINGS (N) onto the LEFT END (B).
Line up the grooves in the MOLDINGS over the heads of the SCREWS in the END.

✚ NOTE: The MOLDINGS should be centered on the END.

✚ NOTE: If the MOLDING comes up off of the SCREWS, remove it and slide it on again.

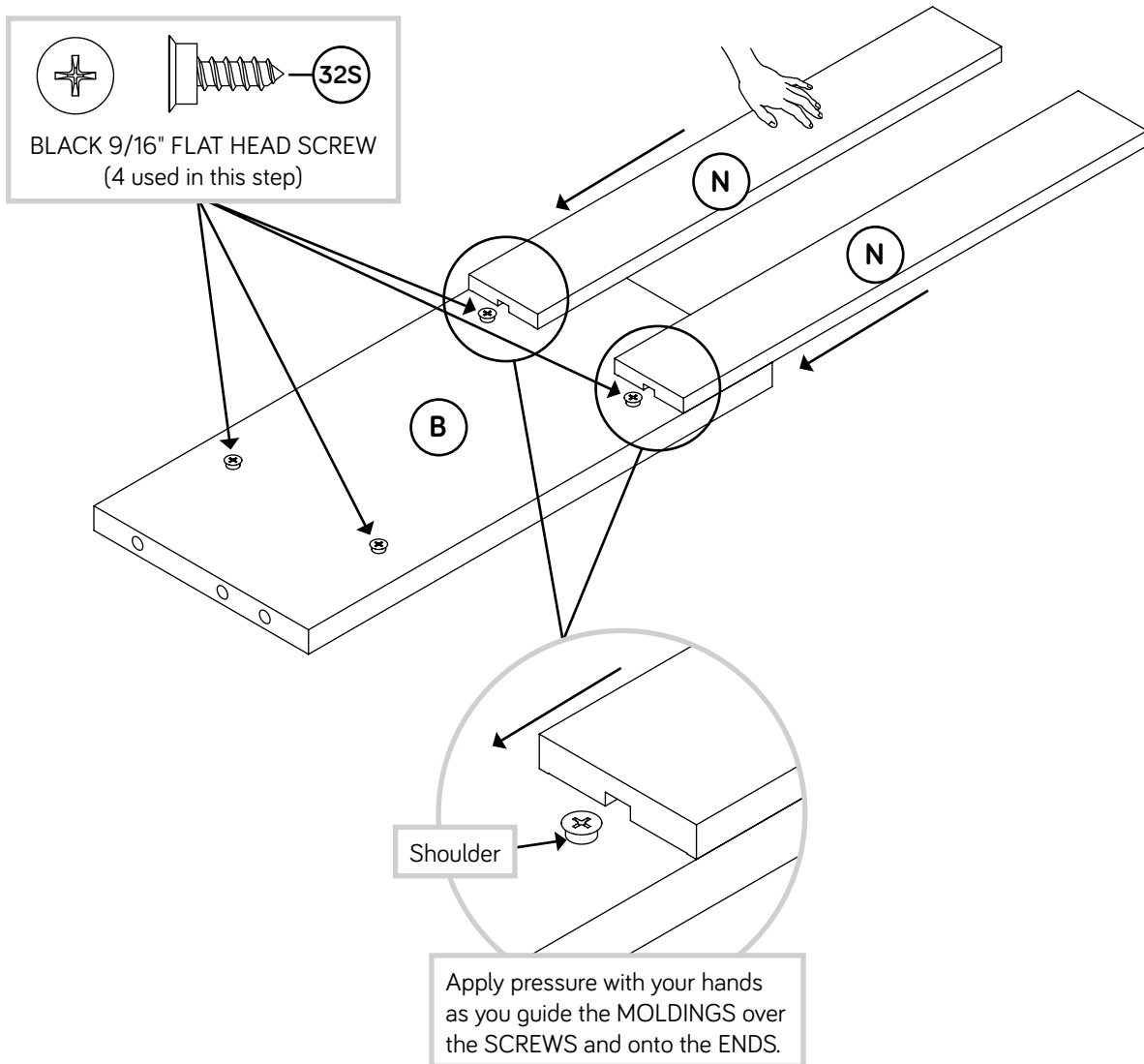

Step 14

- ✚ Carefully turn the LEFT END (B) over.
- ✚ Push six HIDDEN CAMS (1F) into the LEFT END (B) and the remaining SHORT SKIRT (L).
- ✚ Turn twelve CAM SCREWS (8F) into the LEFT END (B), SHORT SKIRT (L), and two of the LEGS (G and J).
- ✚ Insert two WOOD DOWELS (15F) into the LEGS (G and J).

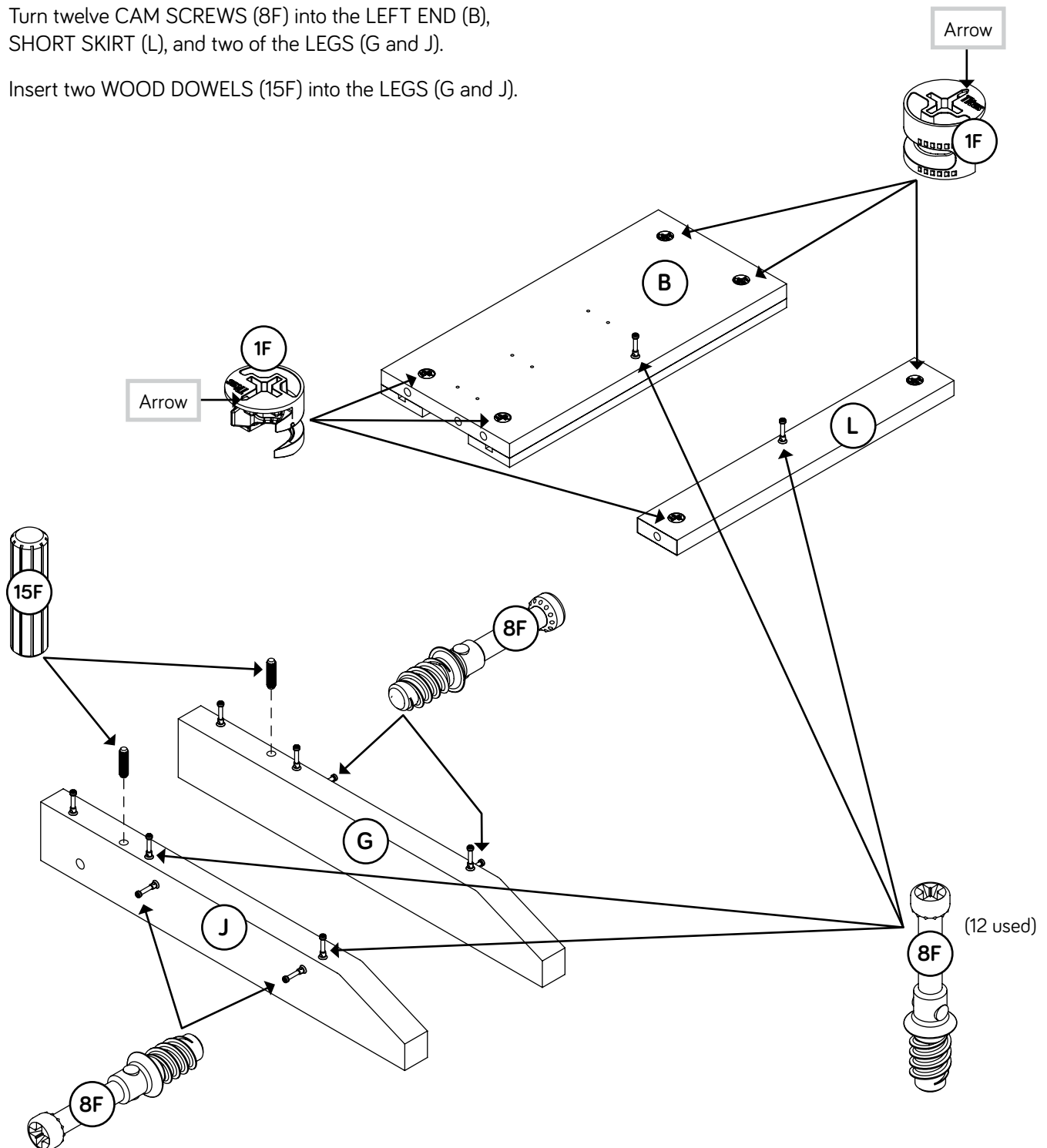

Step 15

- ✚ Fasten the LEGS (G and J) to the LEFT END (B) and SHORT SKIRT (L). Tighten six HIDDEN CAMS.
- ✚ NOTE: Be sure the WOOD DOWELS in the LEGS insert into the LEFT END.

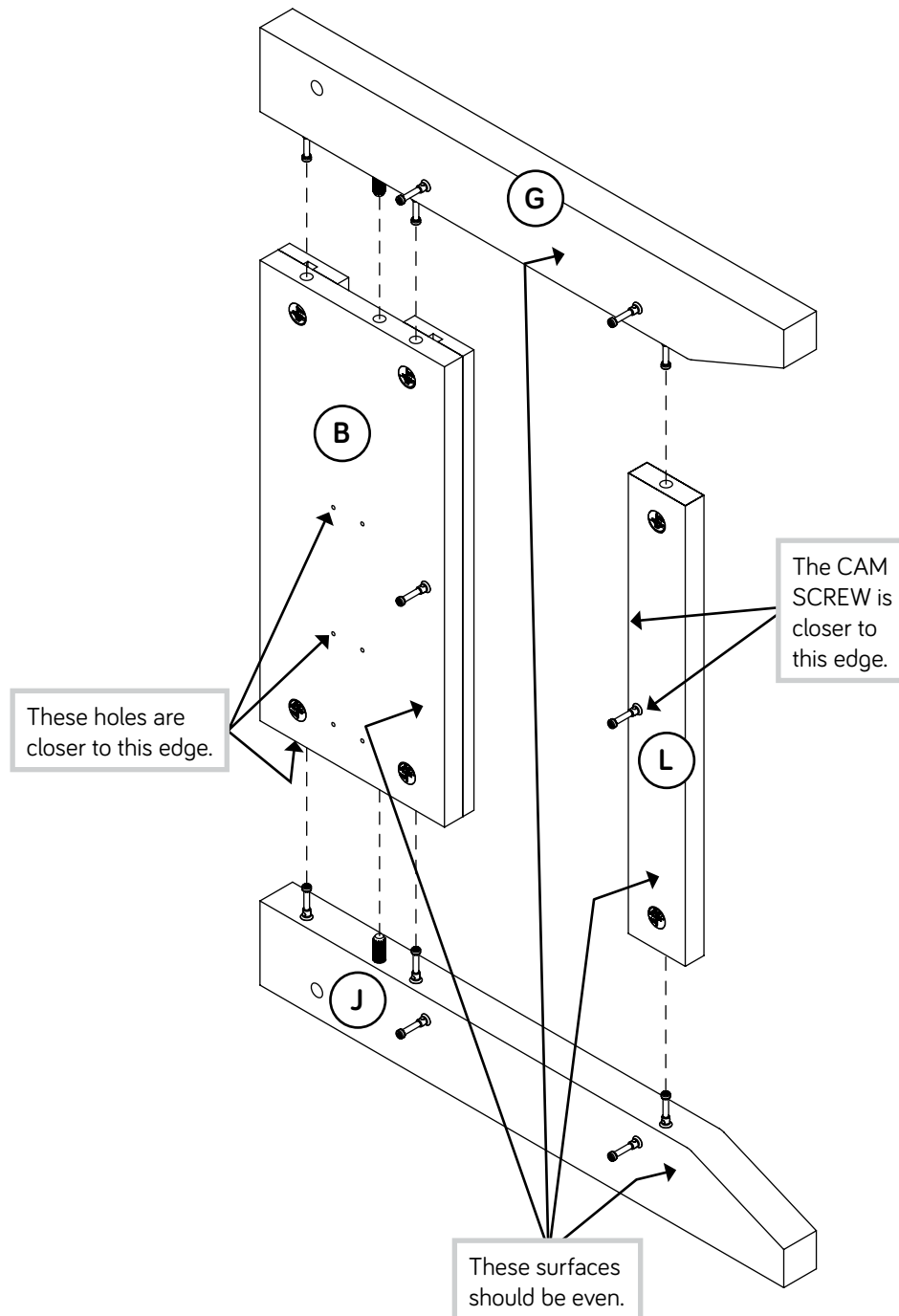

Step 16

- ✚ **NOTE:** You may need to use a Short Screwdriver in this step.
- ✚ Fasten the LEGS (G and J) to the PANELS (Q and R). Tighten two TWIST-LOCK® FASTENERS.
- ✚ Fasten the LEFT END (B) and LEGS (G and J) to the SHELF (D). Tighten three HIDDEN CAMS.
- ✚ Fasten the LEGS (G and J) and SHORT SKIRT (L) to the BOTTOM (E). Tighten three HIDDEN CAMS.

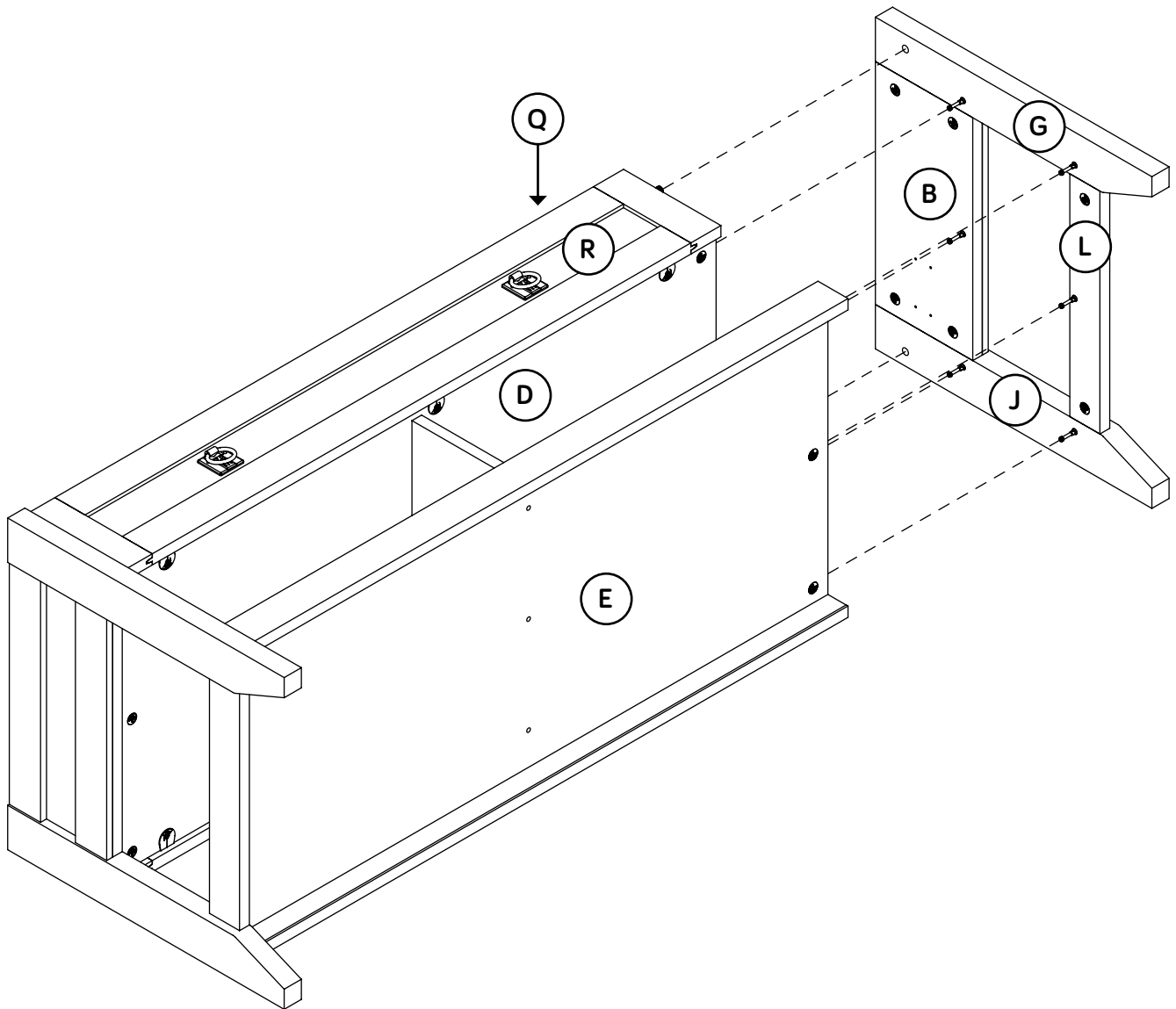

Step 17

Push six BUMPERS (2M) into the TOP (C).

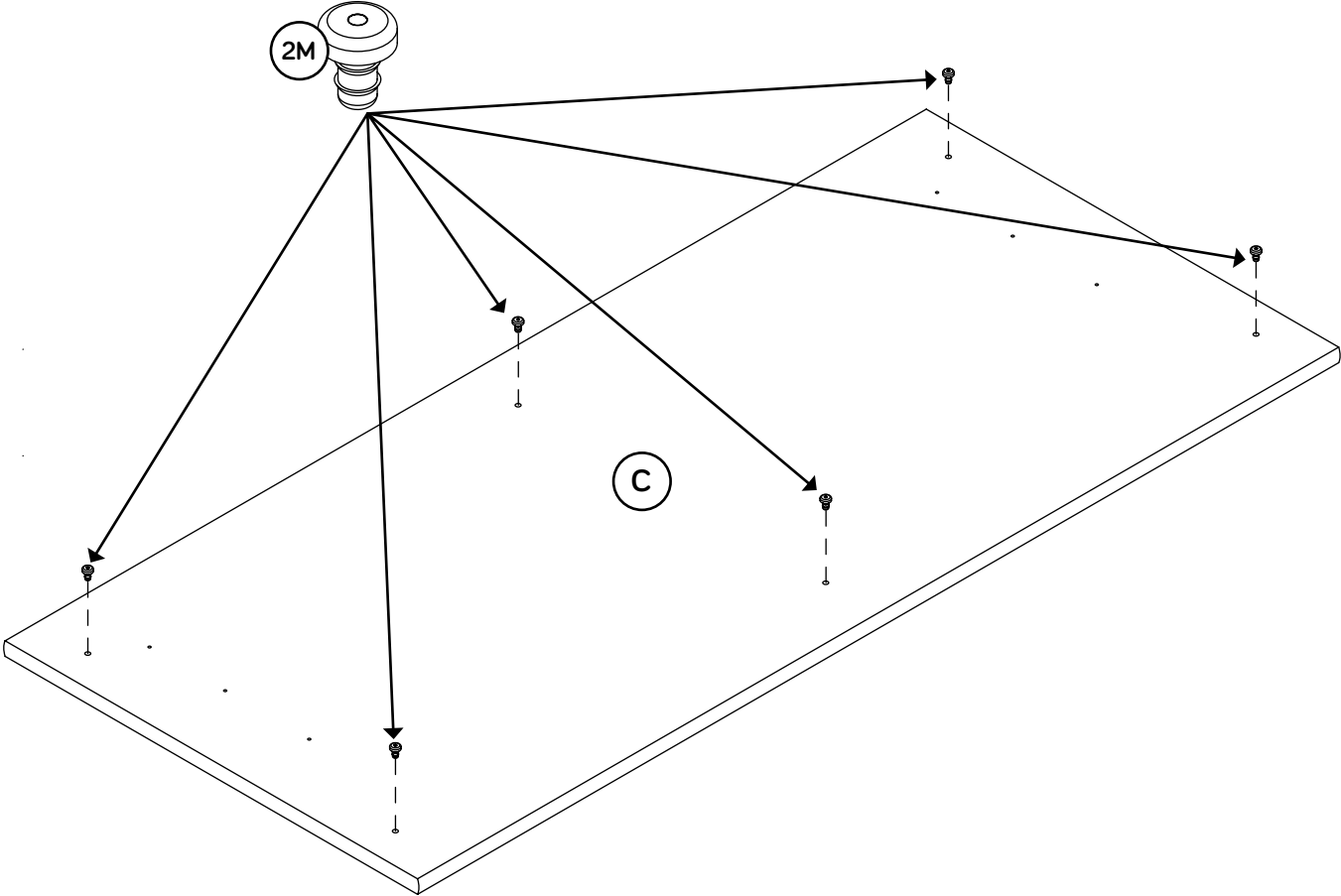

Step 18

First, fasten the front edges of the LIFT TABLE MECHANISMS (23M) to the TOP (C). Use four BLACK 9/16" LARGE HEAD SCREWS (1S).

NOTE: Be sure to position the LIFT TABLE MECHANISMS on the TOP exactly as shown.

Second, press the LIFT TABLE MECHANISM SET (23M) down.

Third, fasten the back edges of the LIFT TABLE MECHANISM SET (23M) to the TOP (C). Use two BLACK 9/16" LARGE HEAD SCREWS (1S).

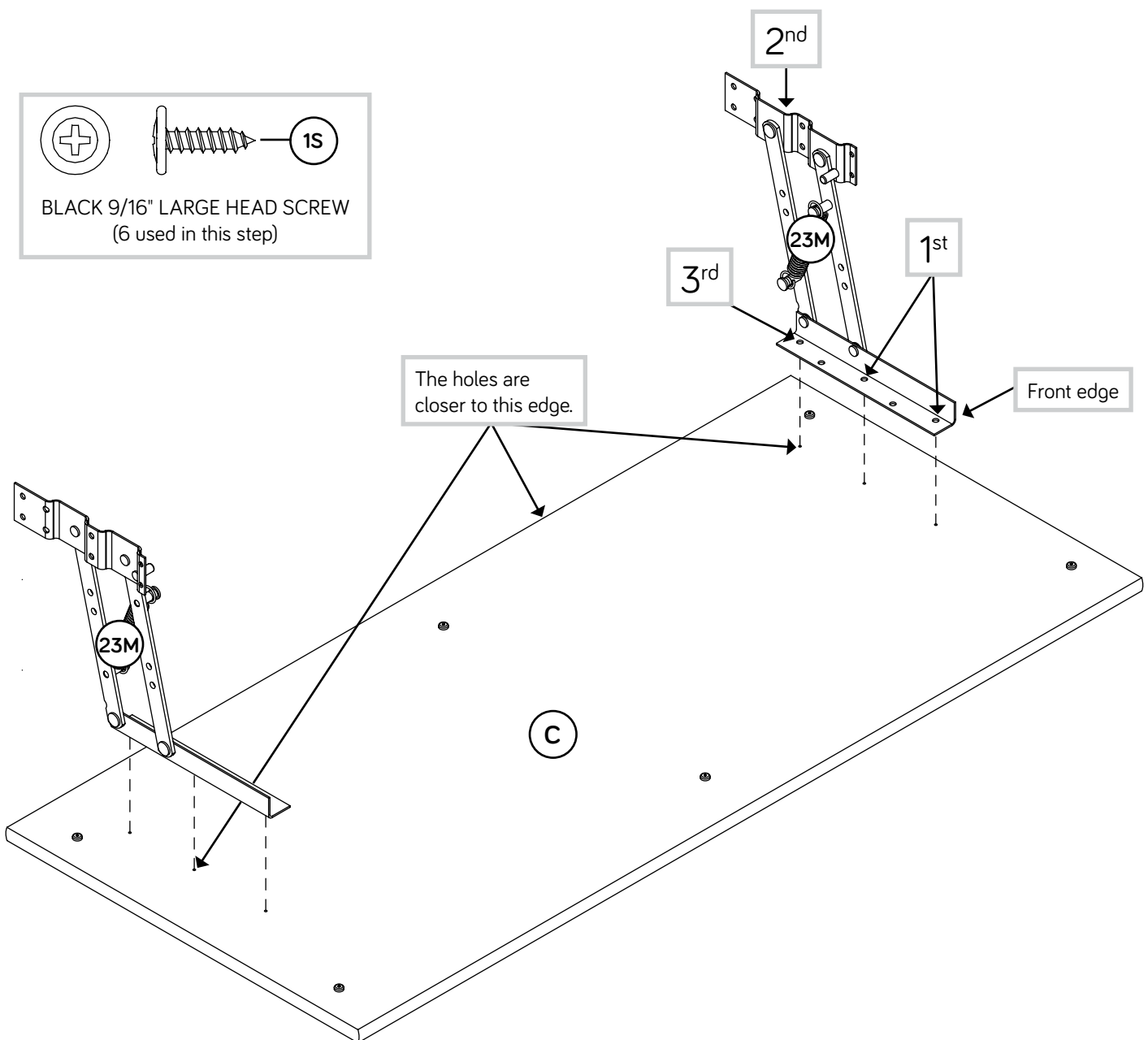

Step 19

Fasten the SUPPORT BRACKETS (37G) to the LIFT TABLE MECHANISMS (23M). Use four SMALL METAL WASHERS (13M), NUTS (24M), and BLACK 3/4" MACHINE SCREWS (92S).

NOTE: Position the SUPPORT BRACKETS exactly as shown.

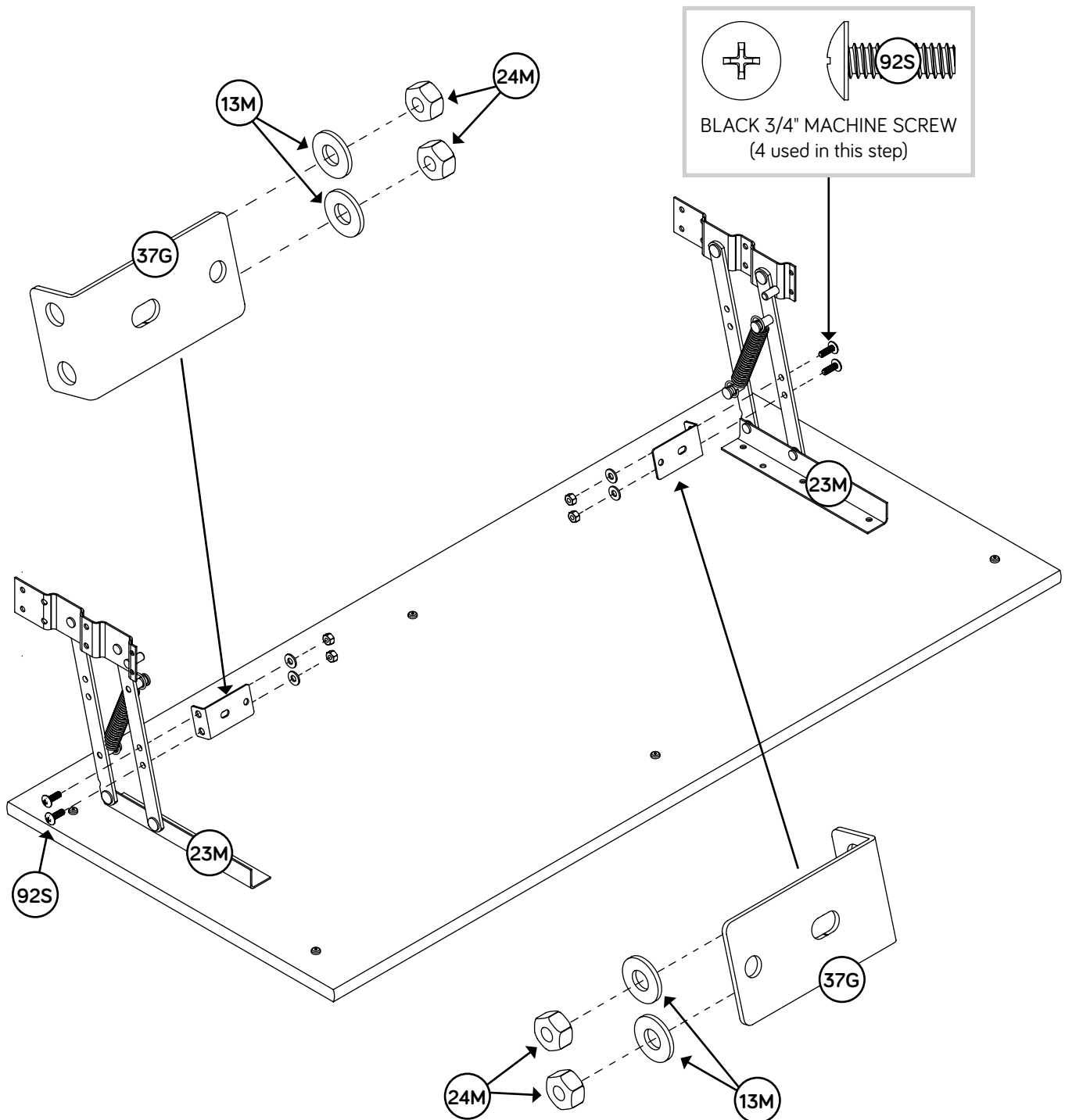

Step 20

IMPORTANT: You will need someone's help in this step.

Fasten the TOP (C) to the ENDS (A and B). Use ten BLACK 9/16" LARGE HEAD SCREWS (1S) through the LIFT TABLE MECHANISMS (23M) and into the holes in the ENDS.

NOTE: Be careful when lining up the holes in the MECHANISMS with the holes in the ENDS as to not damage any parts.

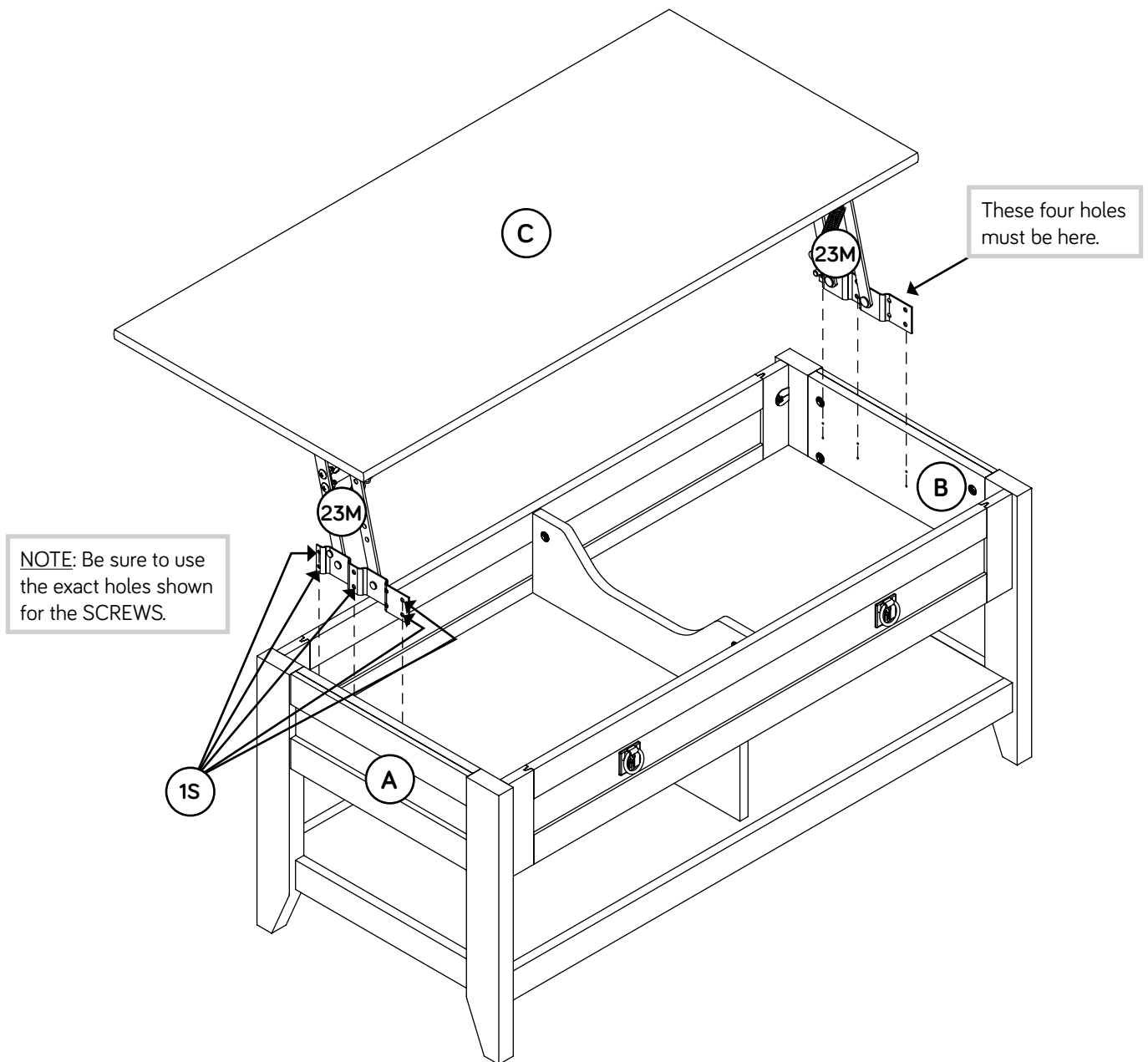
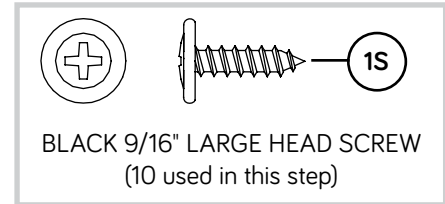

Step 21

- Fasten the BUSHINGS (91M) to the ENDS (A and B). Use two BLACK 3/4" PAN HEAD SCREWS (85S) through the BUSHINGS, through two LARGE METAL WASHERS (80M), through the LIFT TABLE MECHANISMS (23M), and into the ENDS.

NOTE: Do not overtighten the SCREWS.

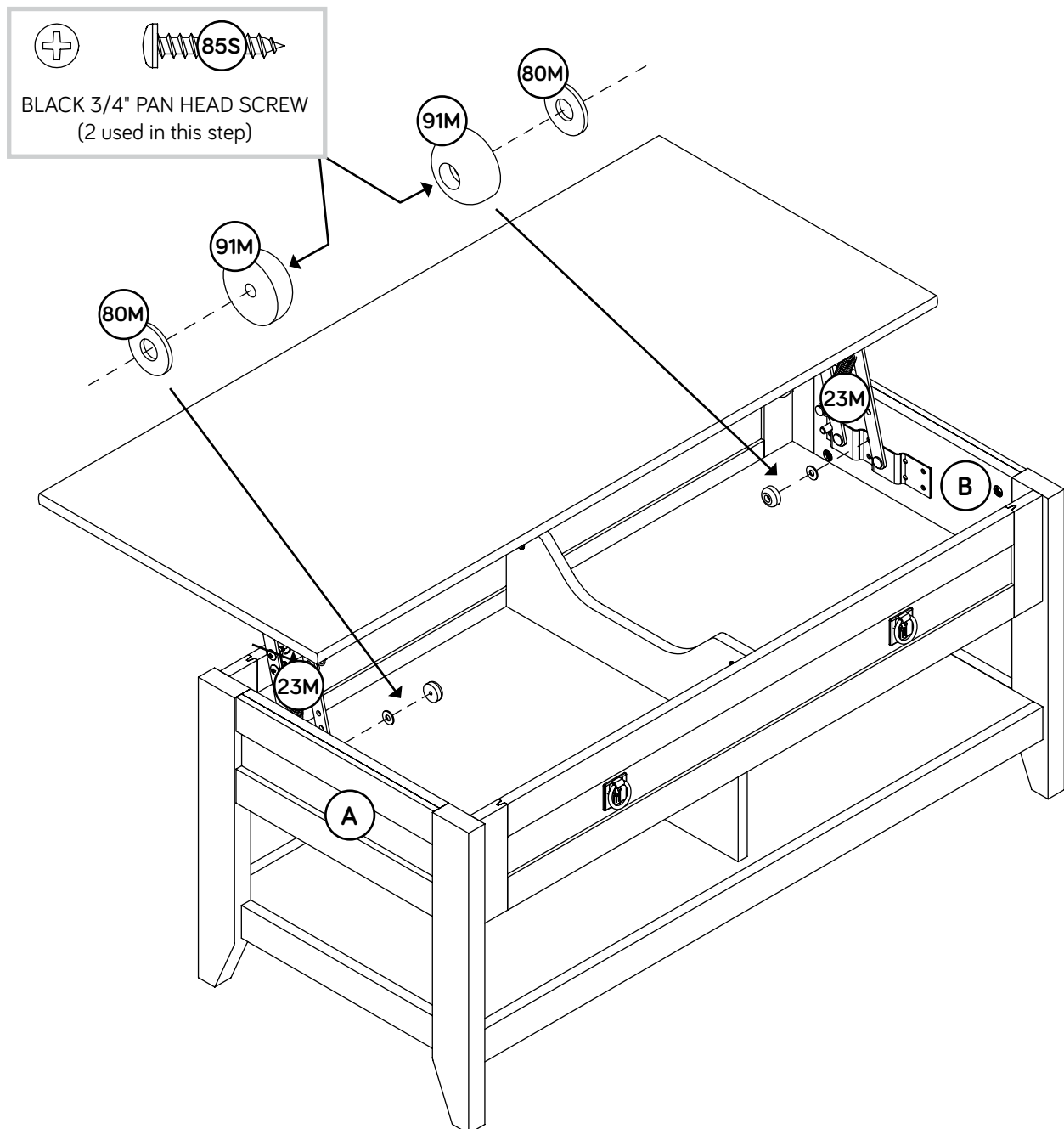

Step 22

Fasten the STRETCHER (F) to the SUPPORT BRACKETS (37G) on the LIFT TABLE MECHANISMS (23M). Use four SMALL METAL WASHERS (13M), NUTS (24M), and BLACK 1-1/4" MACHINE SCREWS (93S).

NOTE: Use an Adjustable Wrench and a Phillips Screwdriver in this step.

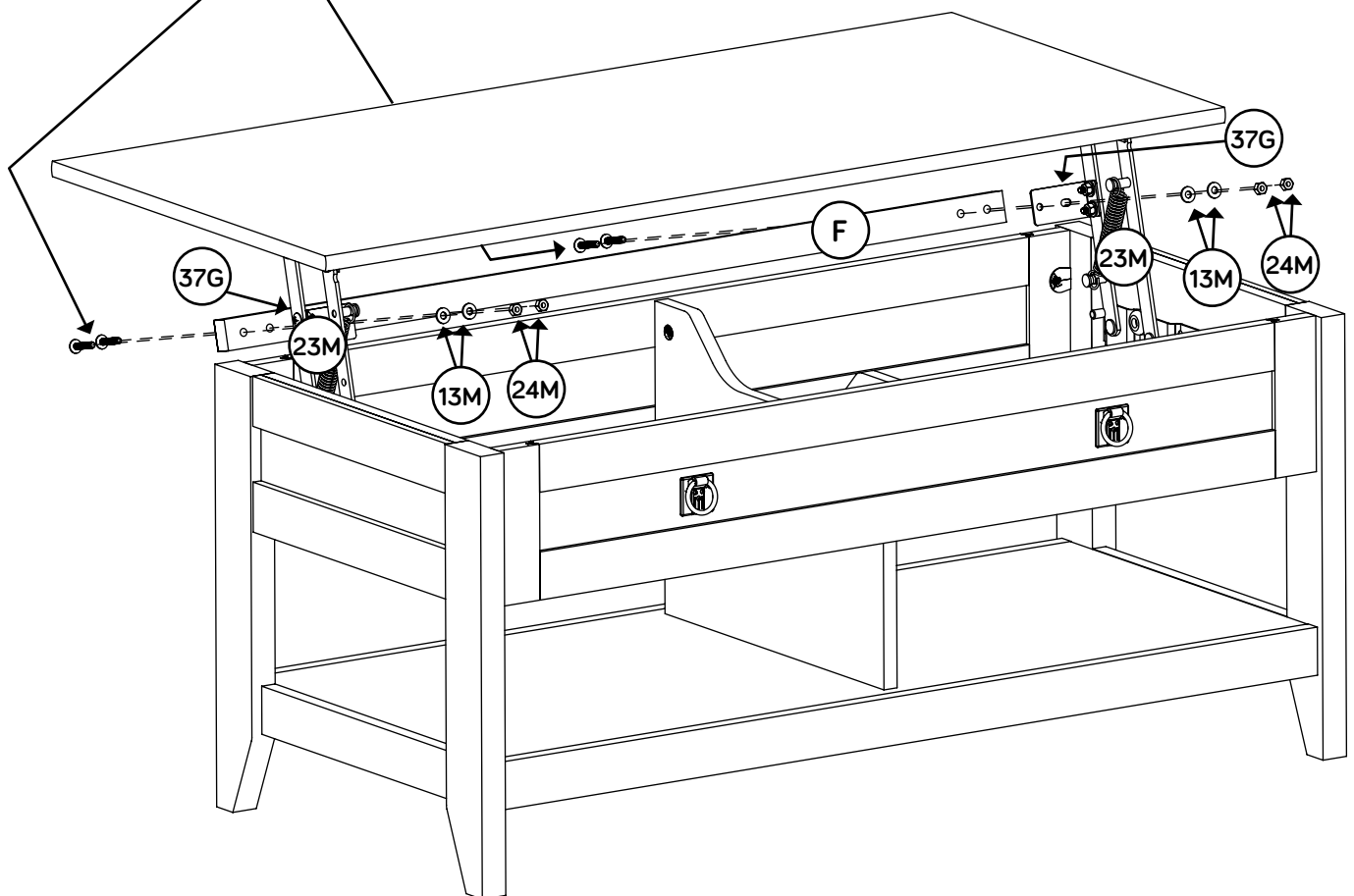
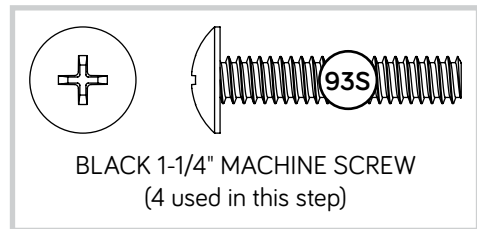

Step 23

- Peel APPLIQUES from the APPLIQUE CARDS (100P) and stick them onto each visible HIDDEN CAM.

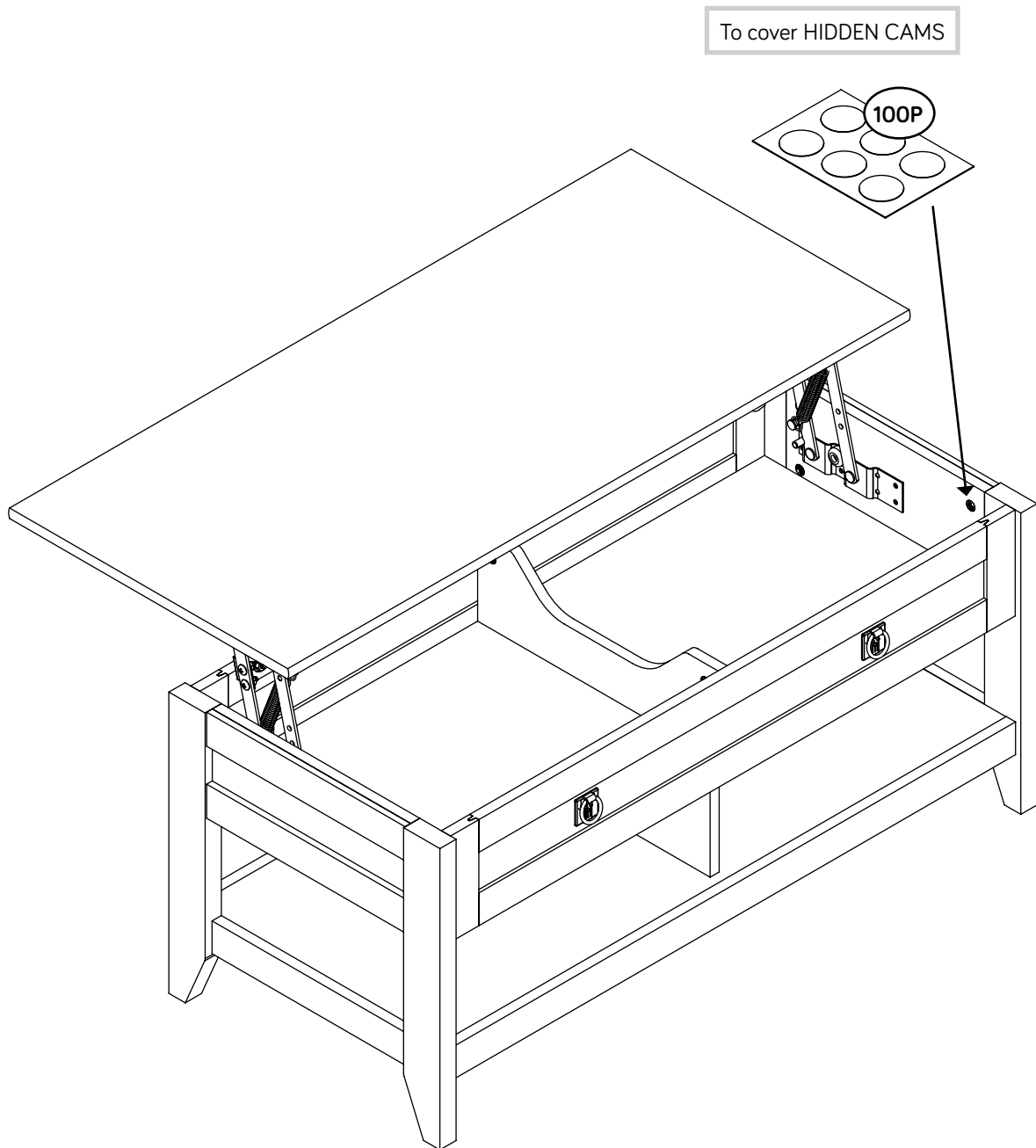

Step 24

- ✚ **IMPORTANT:** Do not place valuables in the storage space.
- ✚ **NOTE:** Please read the back pages of the instruction booklet for important safety information.
- ✚ This completes assembly. Clean with a damp cloth. Wipe dry.

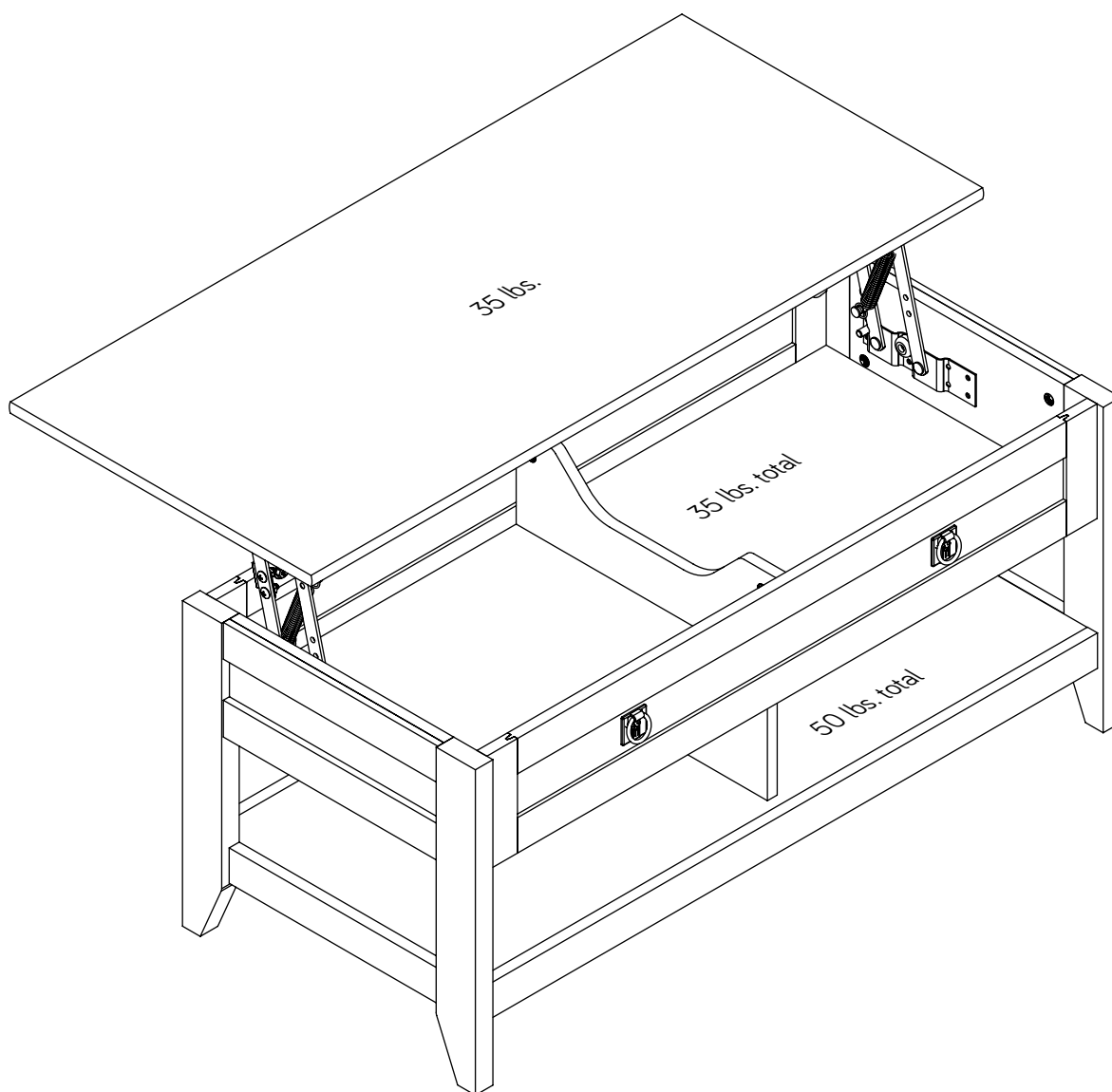

⚠ WARNING

Please use your furniture correctly and safely. Improper use can cause safety hazards, or damage to your furniture or household items. ***Carefully read the following chart.***

Look out for:	What can happen:	How to avoid the problem:
<ul style="list-style-type: none">• Overloaded shelves.	<ul style="list-style-type: none">• Risk of injury.• Top-heavy furniture can tip over.• Overloaded shelves can break.	<ul style="list-style-type: none">• Never exceed the weight limits shown in the instructions.• Work from bottom to top when loading shelves. Place the heavier items on the lower shelves.
<ul style="list-style-type: none">• Placing TVs on furniture items that are not designed to support a television is hazardous.	<ul style="list-style-type: none">• Risk of injury or death. TVs can be very heavy. Plus the weight and location of the picture tube tends to make TVs unbalanced and prone to tipping forward.	<ul style="list-style-type: none">• This product is not designed to support a television.